

# Espacio de Arte Contemporáneo

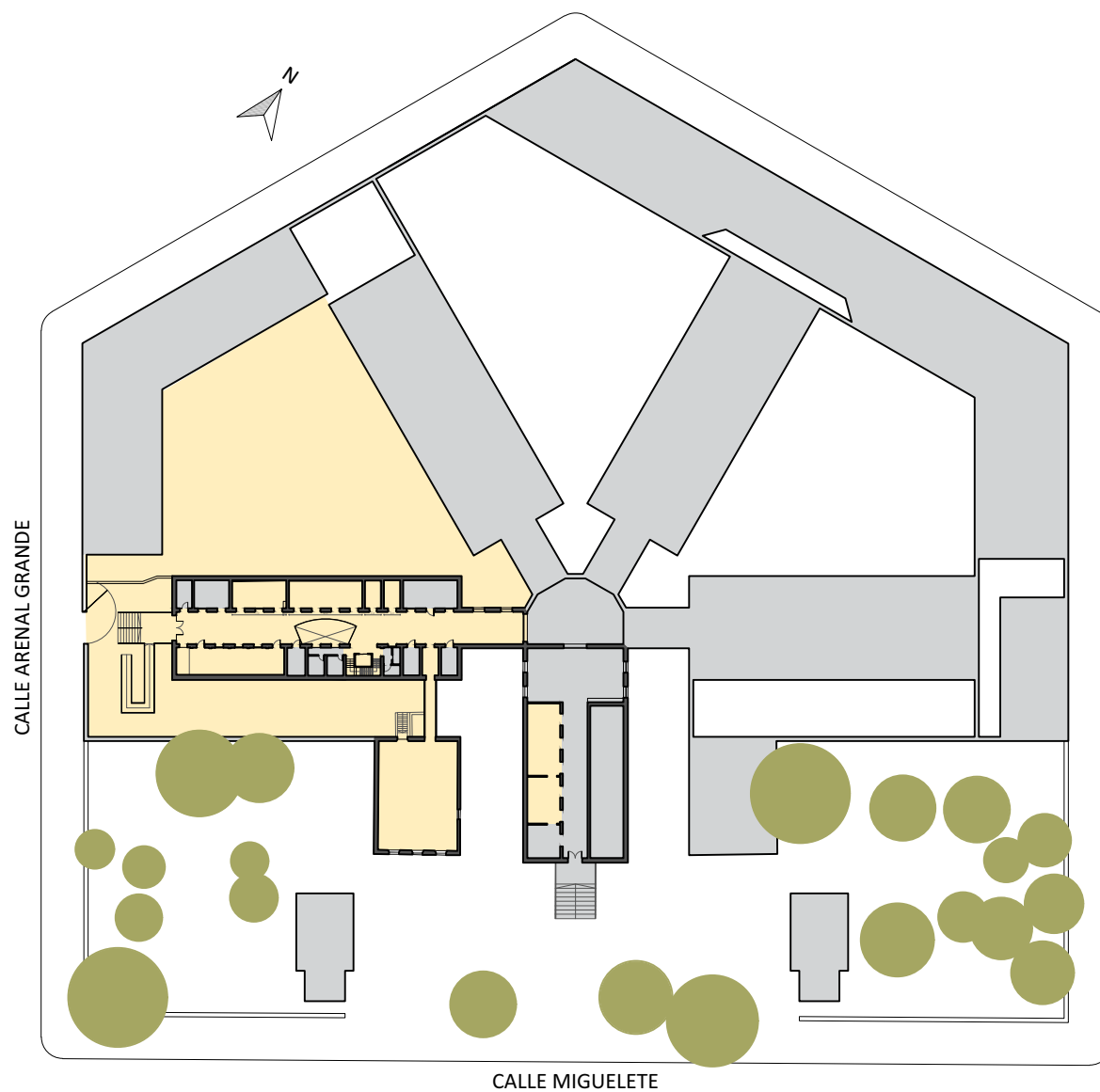

Espacios expositivos.  
Planos de salas.

# Sala Cero y Sala Doble Cero

Planta baja y  
ubicación de sala  
Escala 1:500

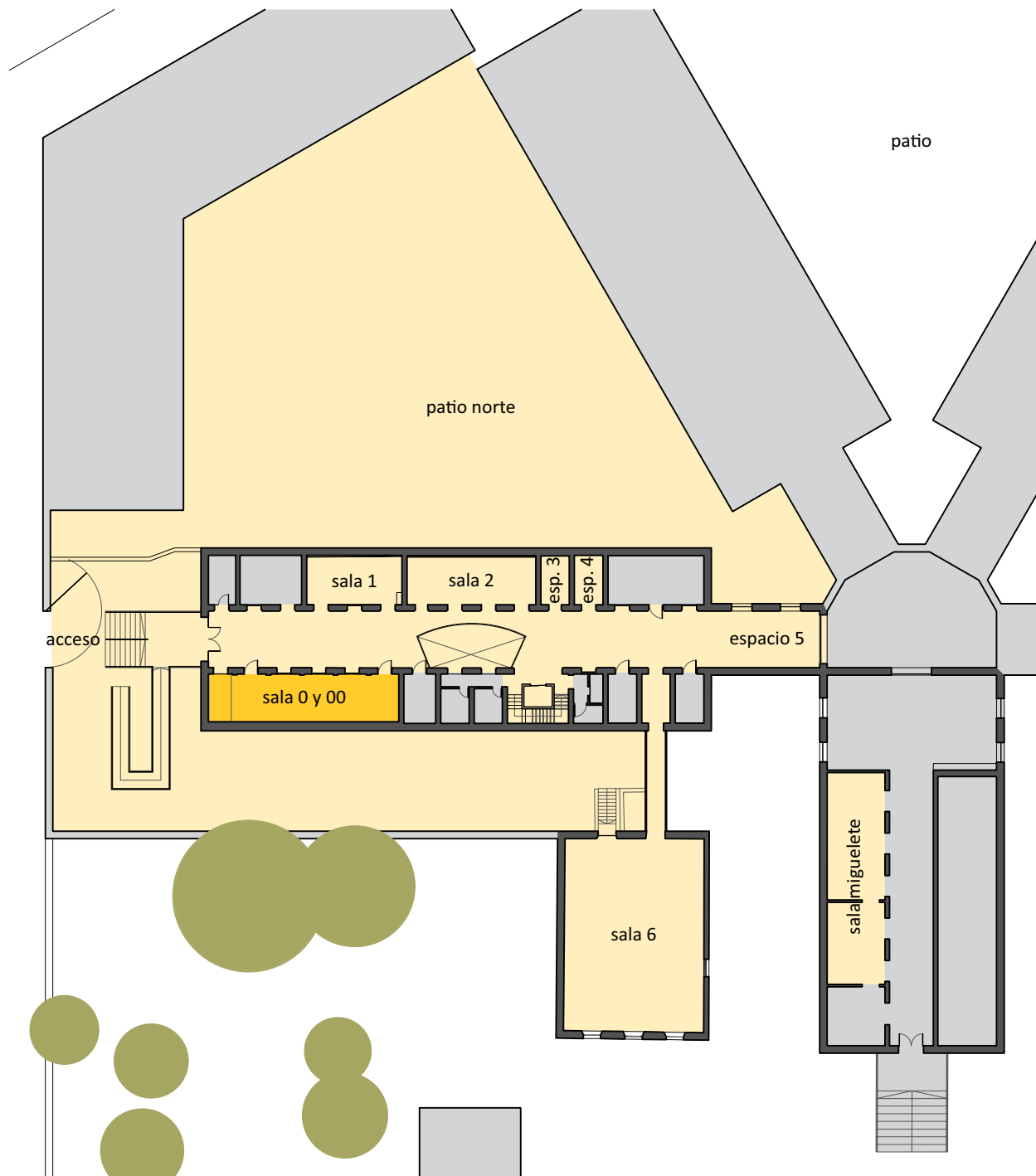

# Sala Cero y Sala Doble Cero



Vistas Sala Cero



Vista Sala Doble Cero

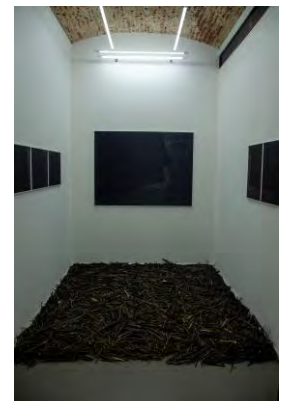

# Sala Cero y Sala Doble Cero

Planta  
Escala 1:100

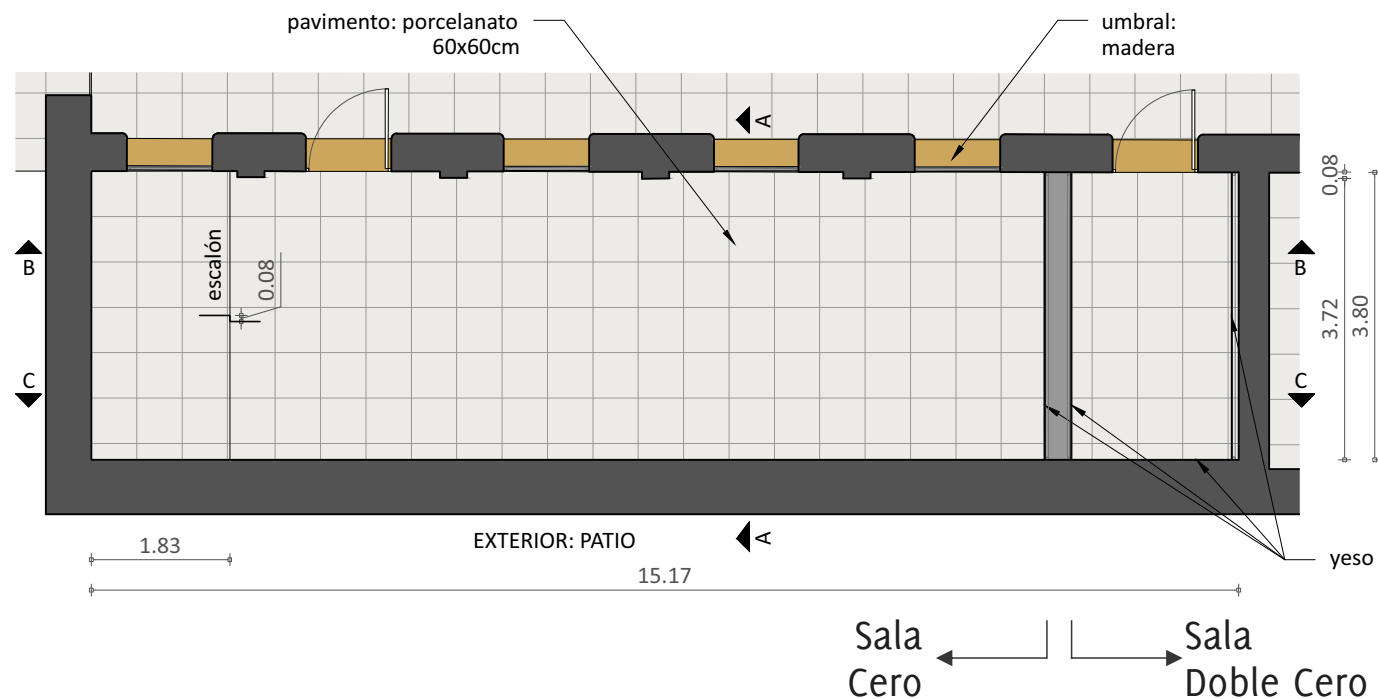

Corte AA  
Escala 1:100

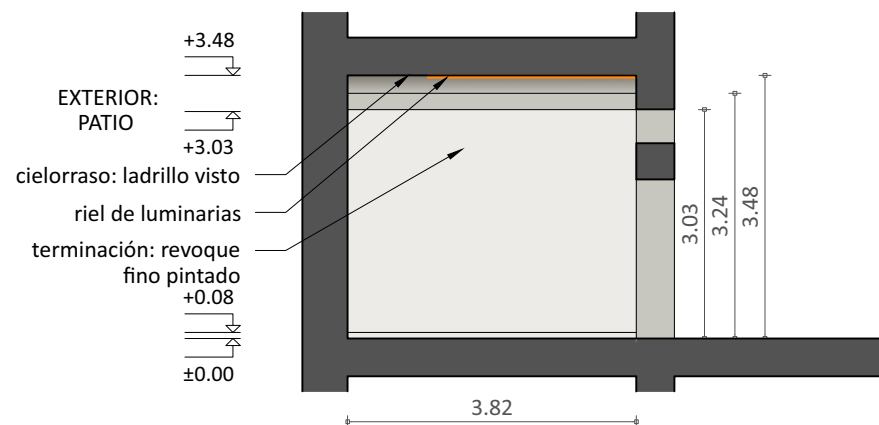

Nota:

Eventualmente si el proyecto lo requiere, la Sala Doble Cero puede ser integrada a la Sala Cero.



# Sala Uno

Planta baja y  
ubicación de sala  
Escala 1:500

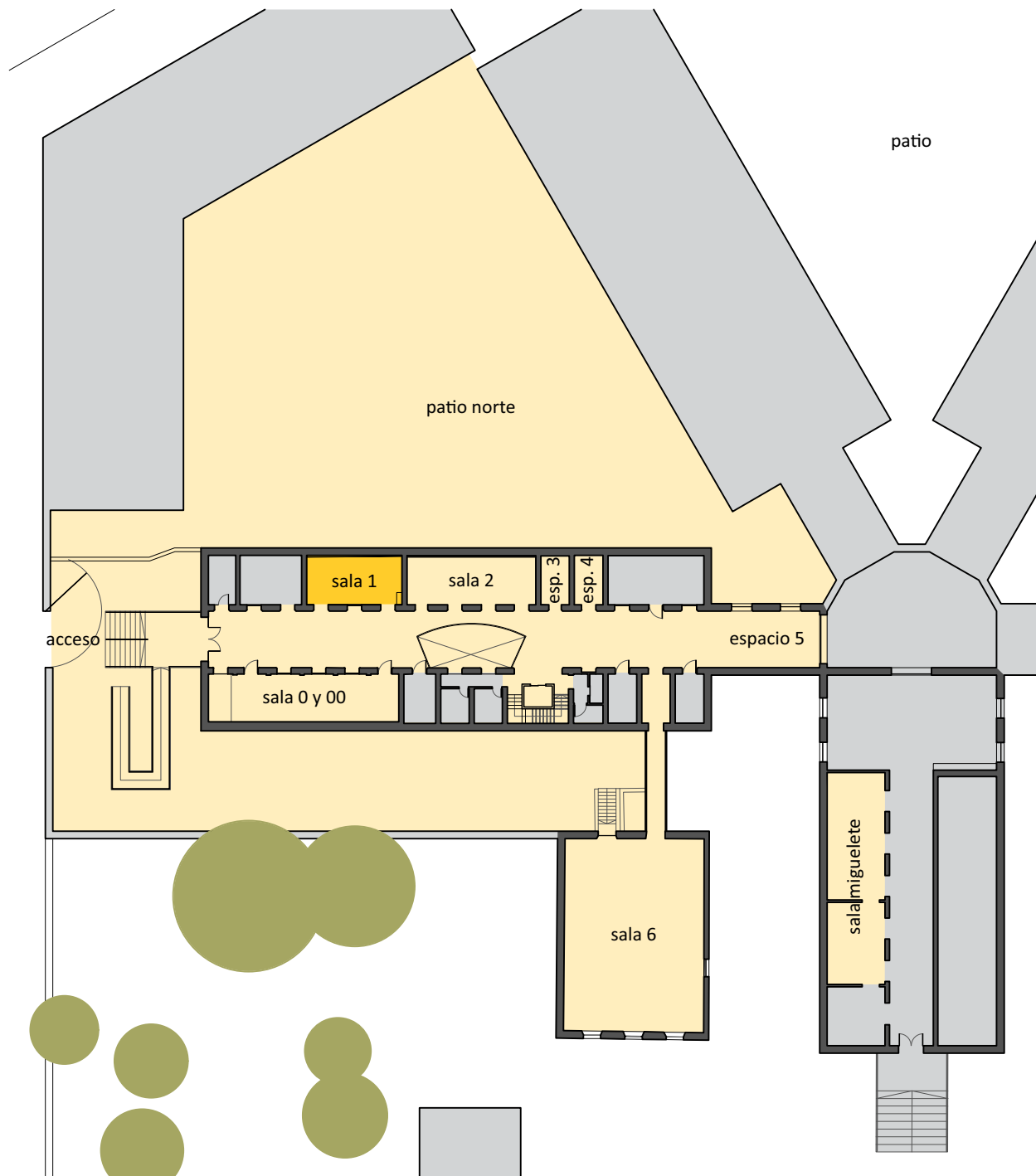

# Sala Uno



# Vistas

# Sala Uno

## Planta

Escala 1:100



## Corte AA

Escala 1:100

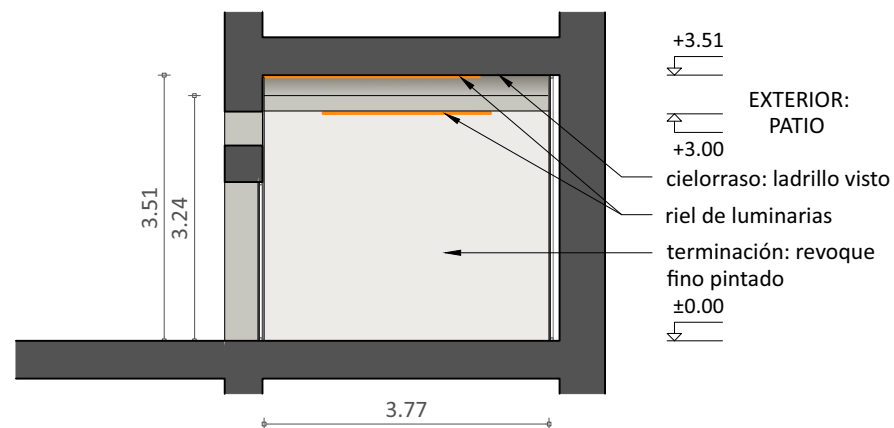



# Sala Uno

## Corte BB

Escala 1:100

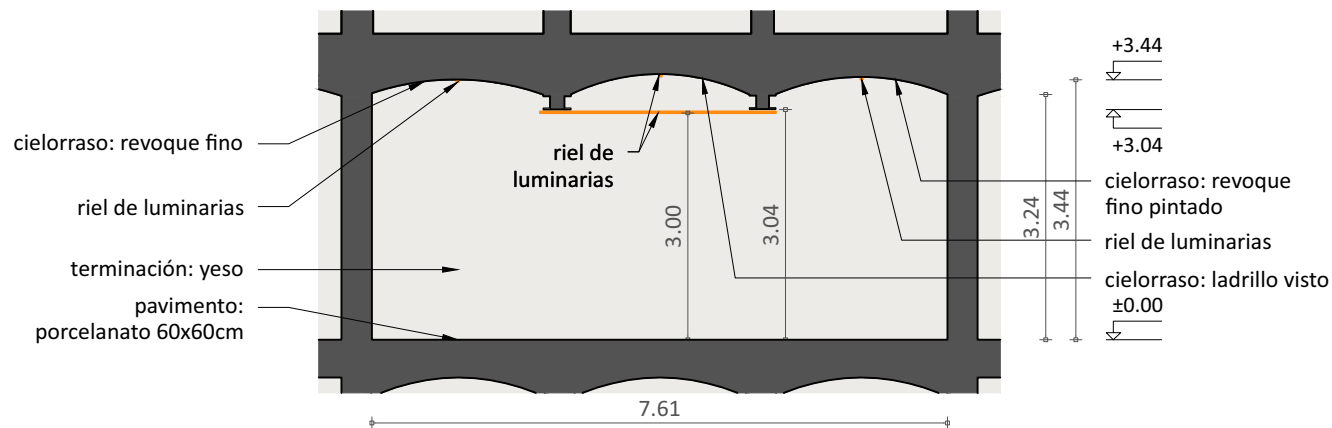

## Corte CC

Escala 1:100

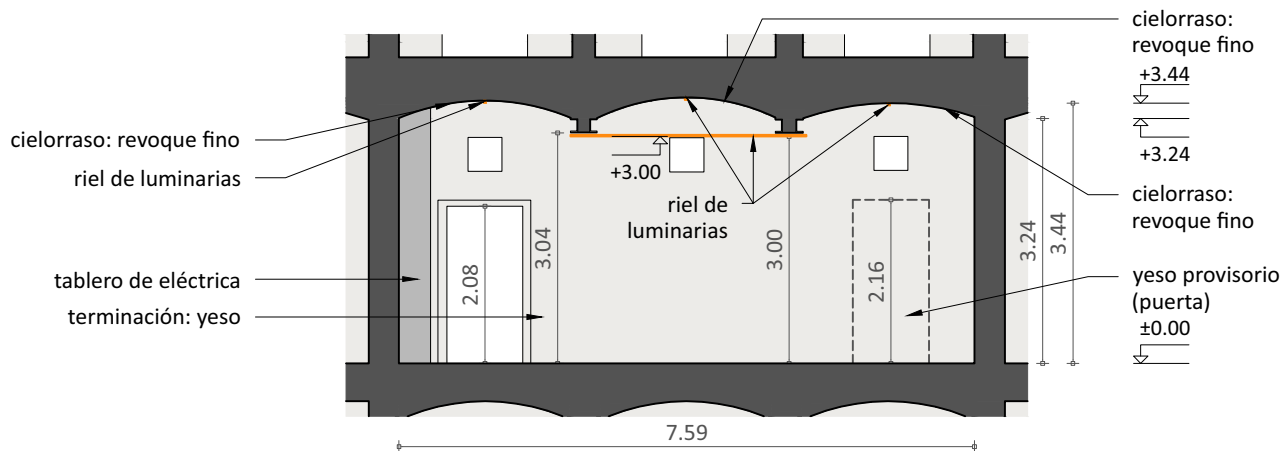

# Sala Dos

Planta baja y  
ubicación de sala  
Escala 1:500



# Sala Dos



# Vistas



# Sala Dos

## Planta

Escala 1:100

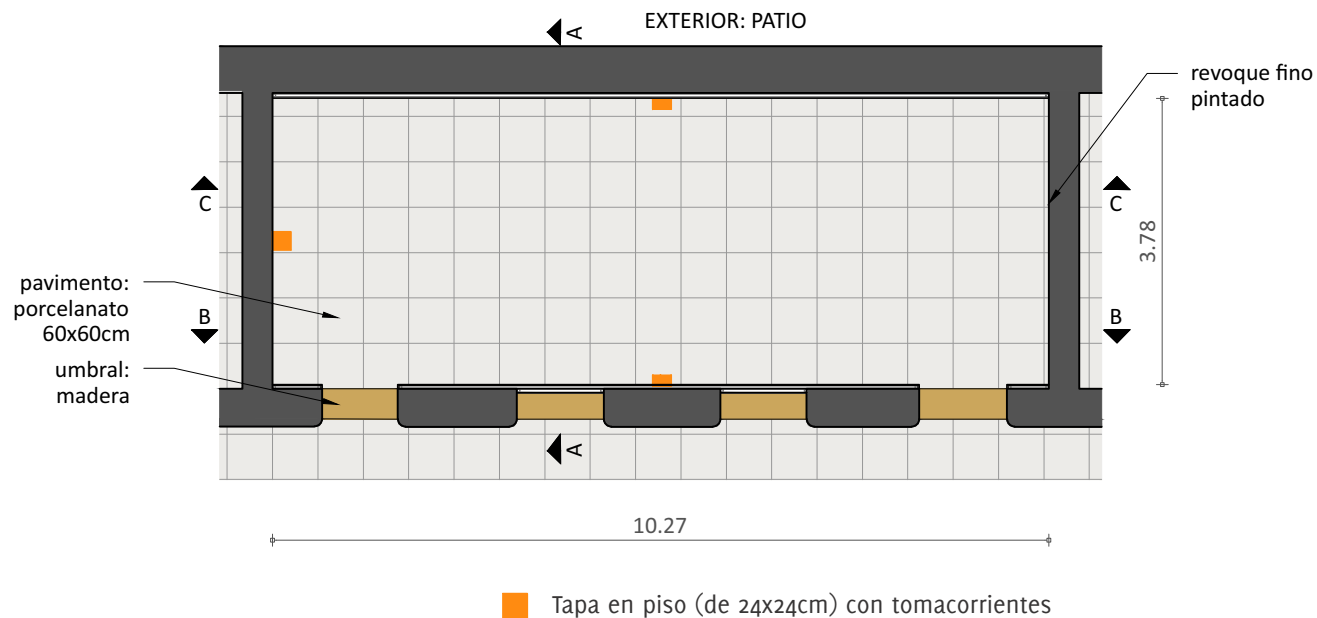

## Corte AA

Escala 1:100

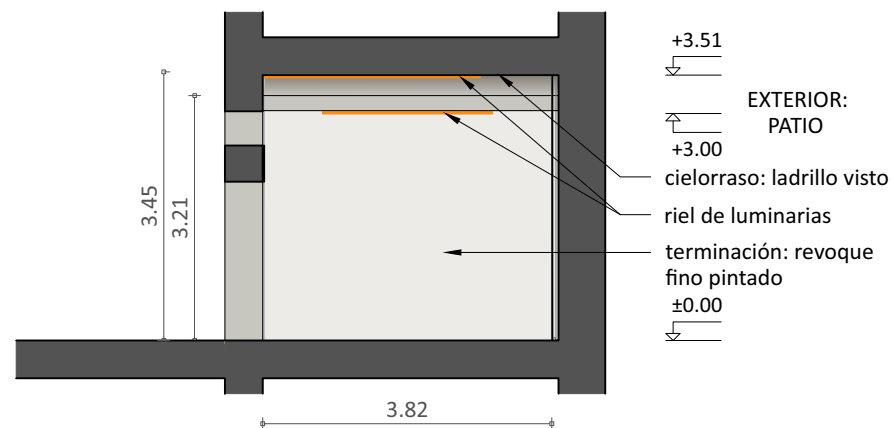

# Sala Dos

## Corte BB

Escala 1:100

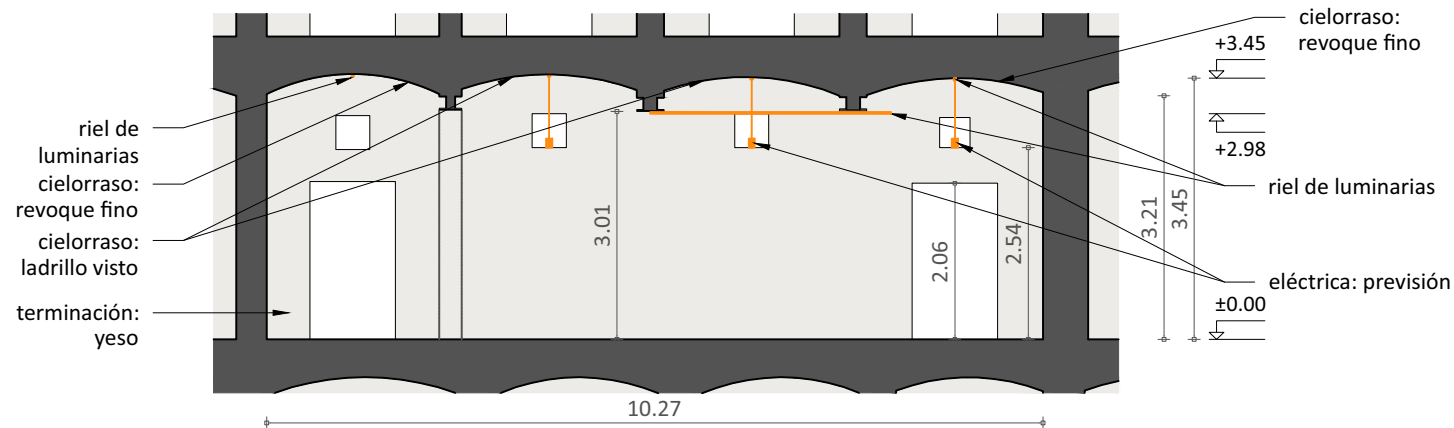

## Corte CC

Escala 1:100

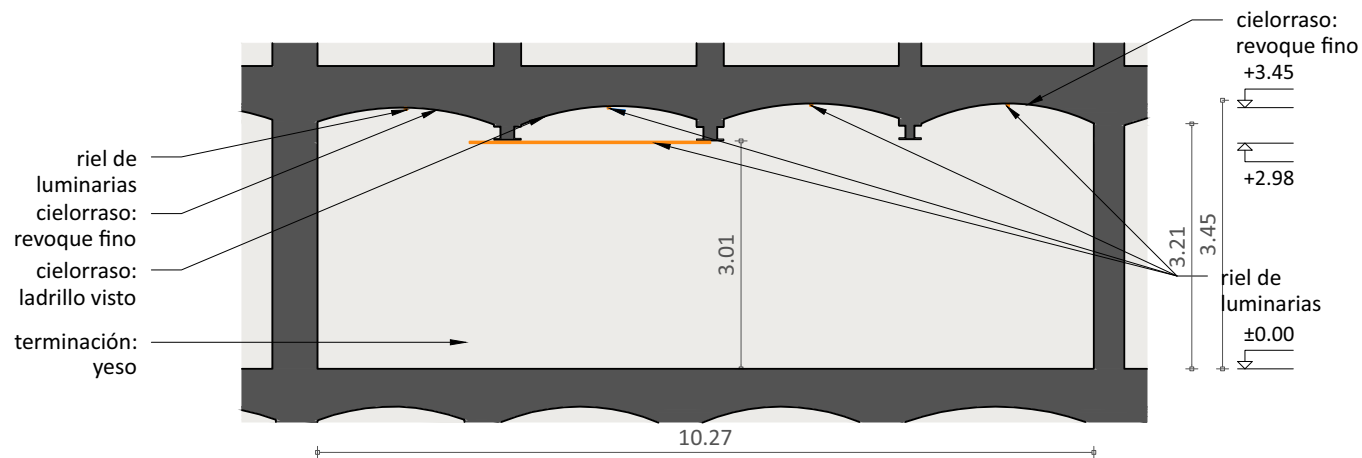

# Espacio Tres

Planta baja y  
ubicación de sala  
Escala 1:500

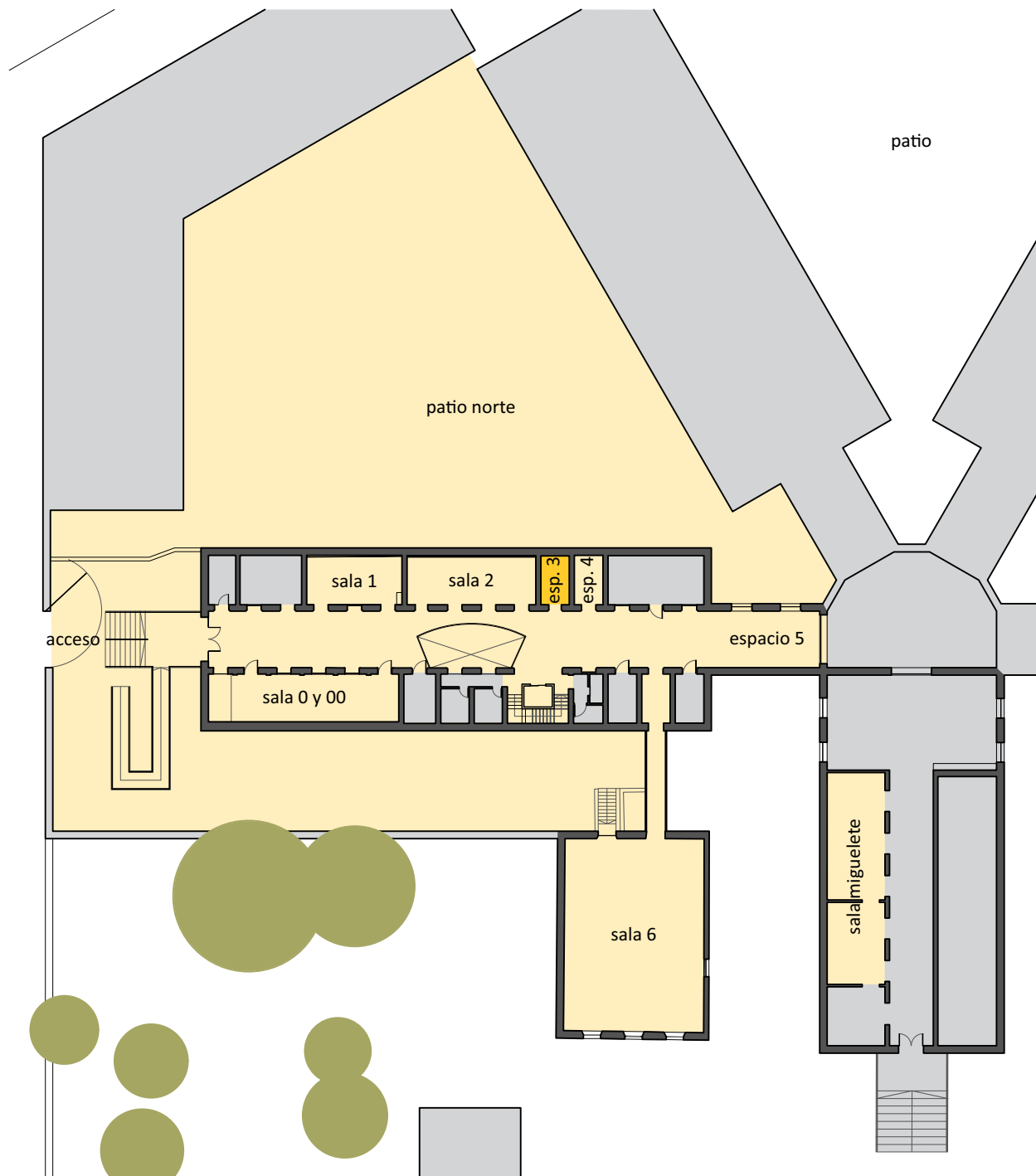

# Espacio Tres



## Vistas



# Espacio Tres

## Planta

Escala 1:100

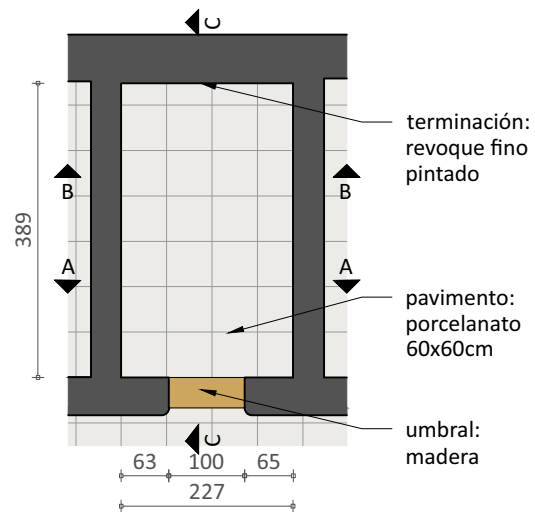

## Corte AA

Escala 1:100

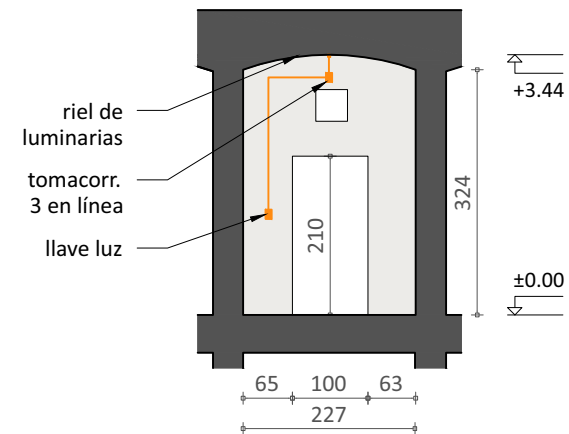

## Corte BB

Escala 1:100

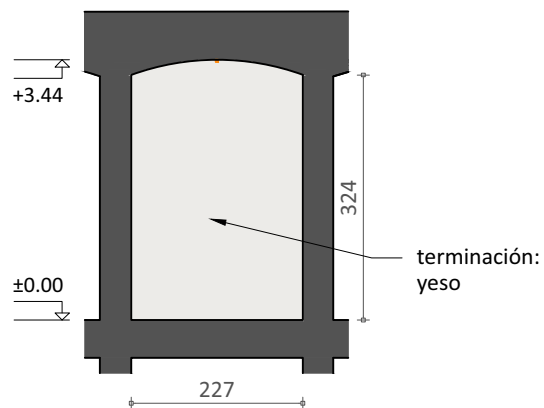

## Corte CC

Escala 1:100

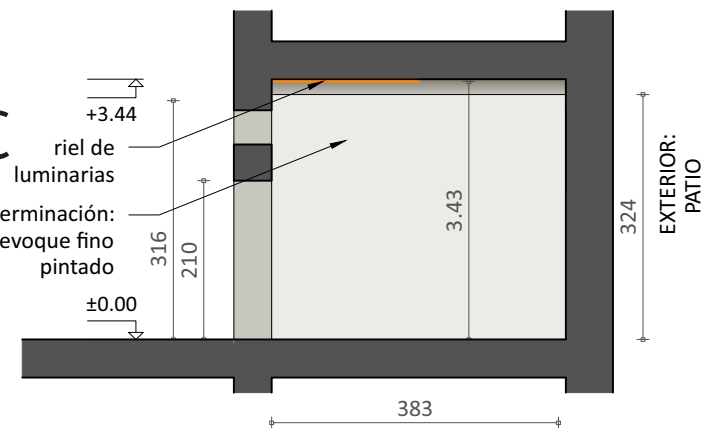



# Espacio Cuatro

Planta baja y  
ubicación de sala  
Escala 1:500

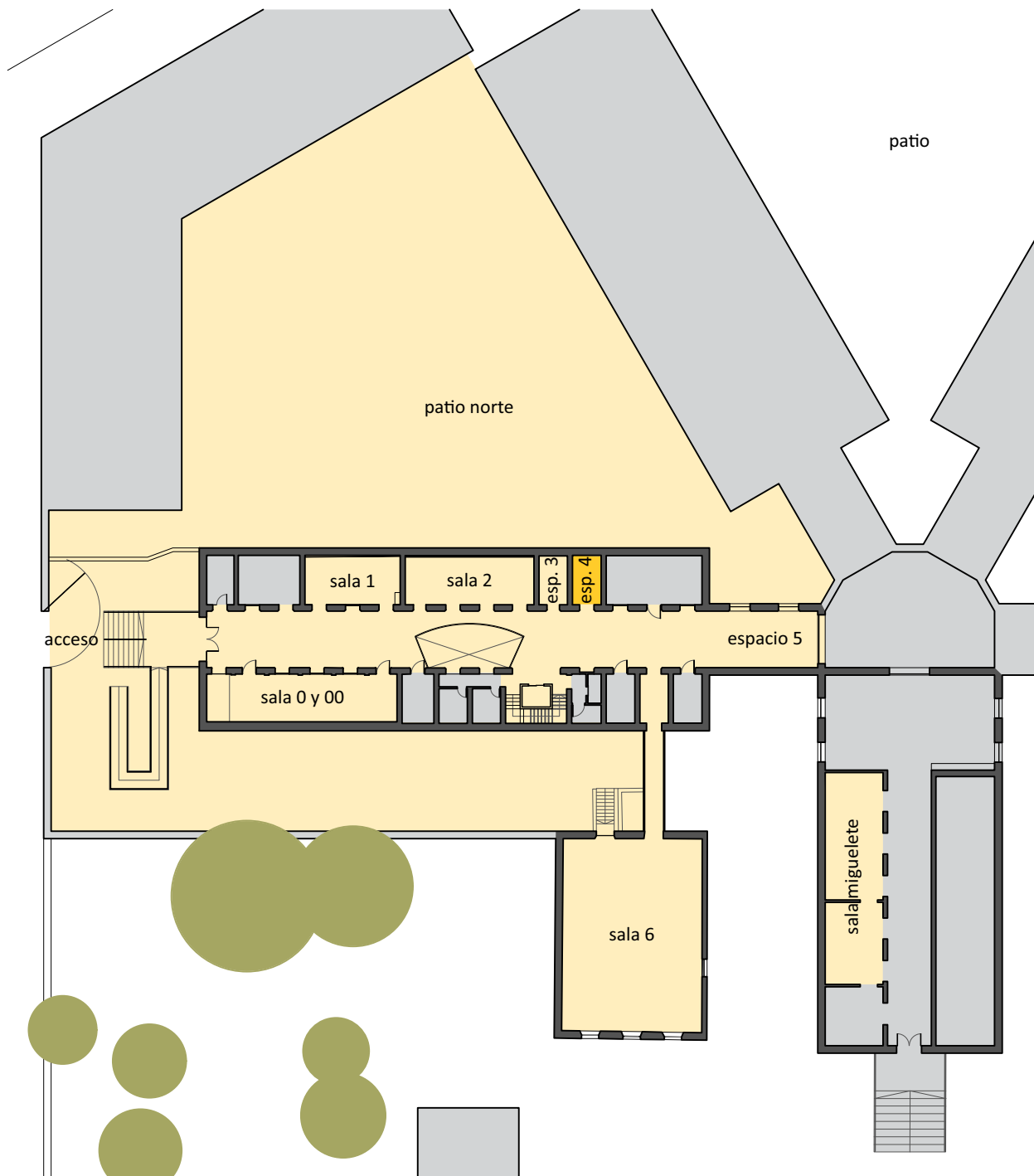

# Espacio Cuatro



## Vistas

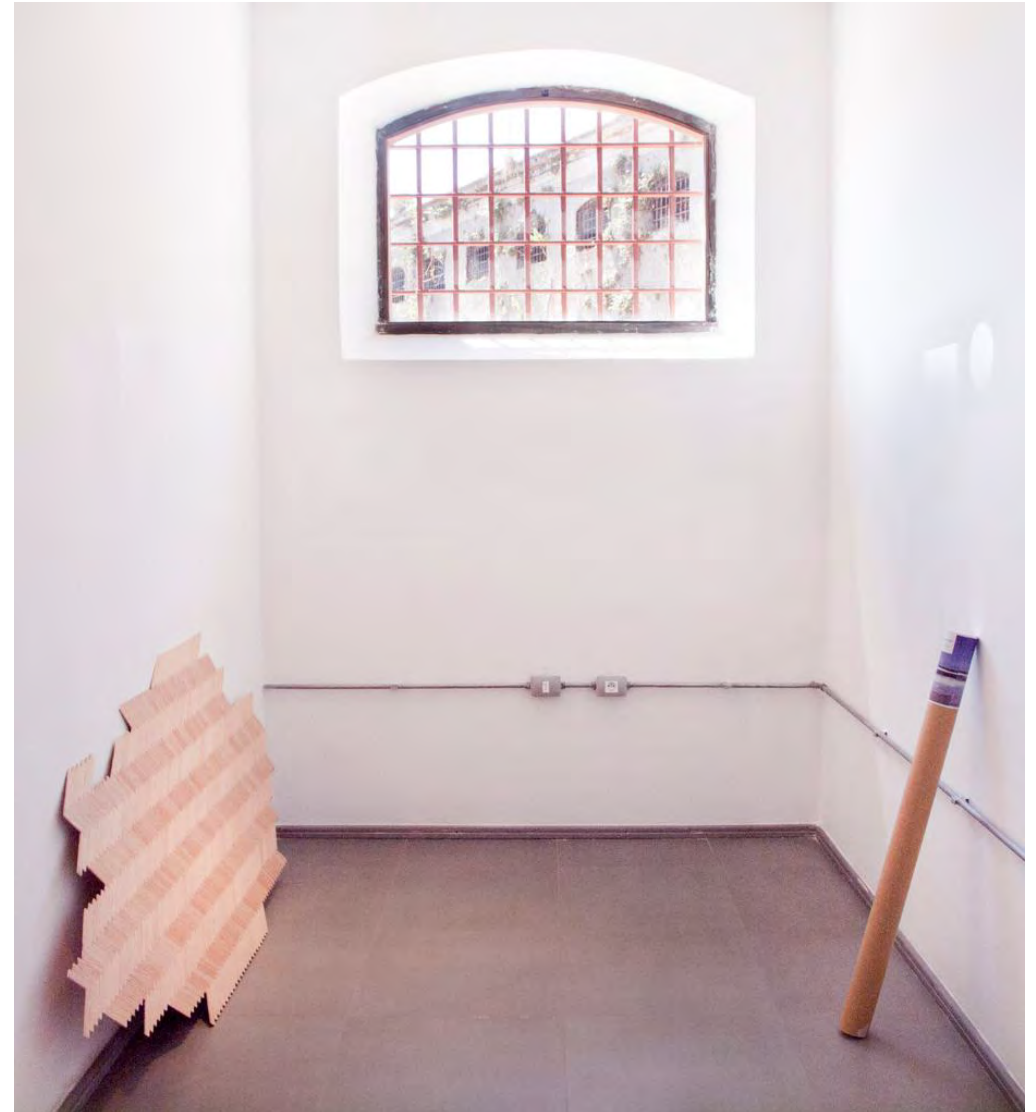

# Espacio Cuatro

Planta  
Escala 1:100

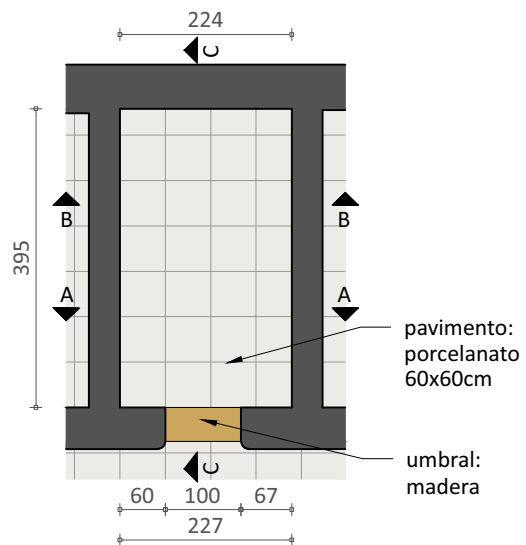

Corte AA  
Escala 1:100

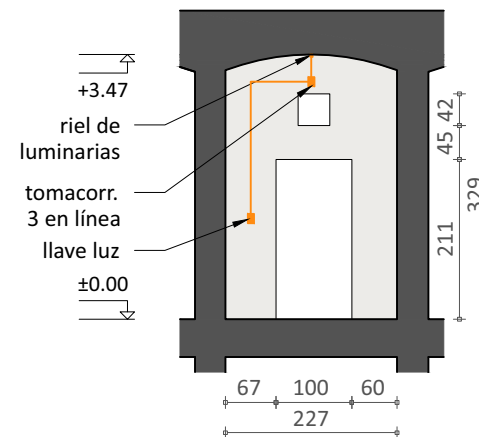

Corte BB  
Escala 1:100

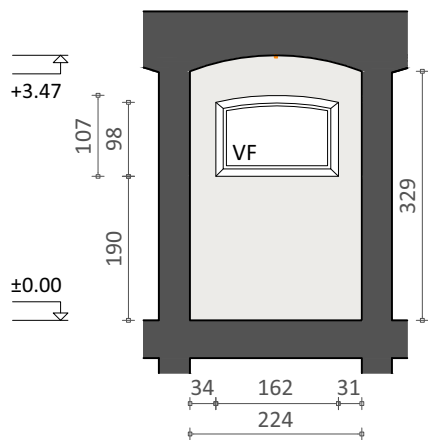

Corte CC  
Escala 1:100

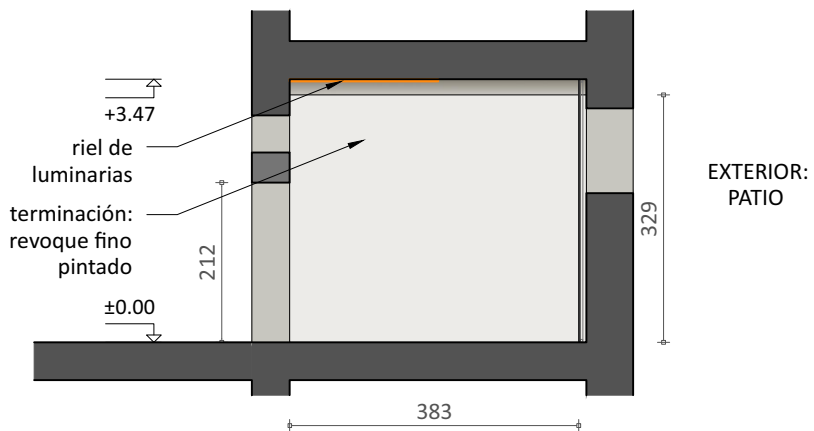

# Espacio Cinco

Planta baja y  
ubicación de sala  
Escala 1:500



# Espacio Cinco



# Vistas



# Espacio Cinco

Planta  
Escala 1:100

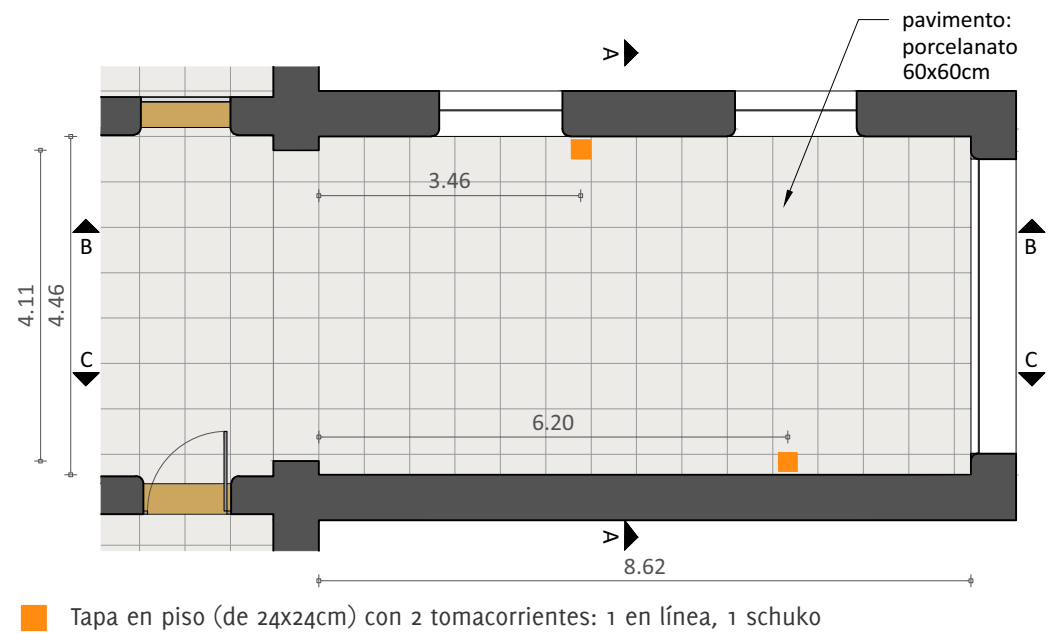

# Espacio Cinco

## Corte AA

Escala 1:100

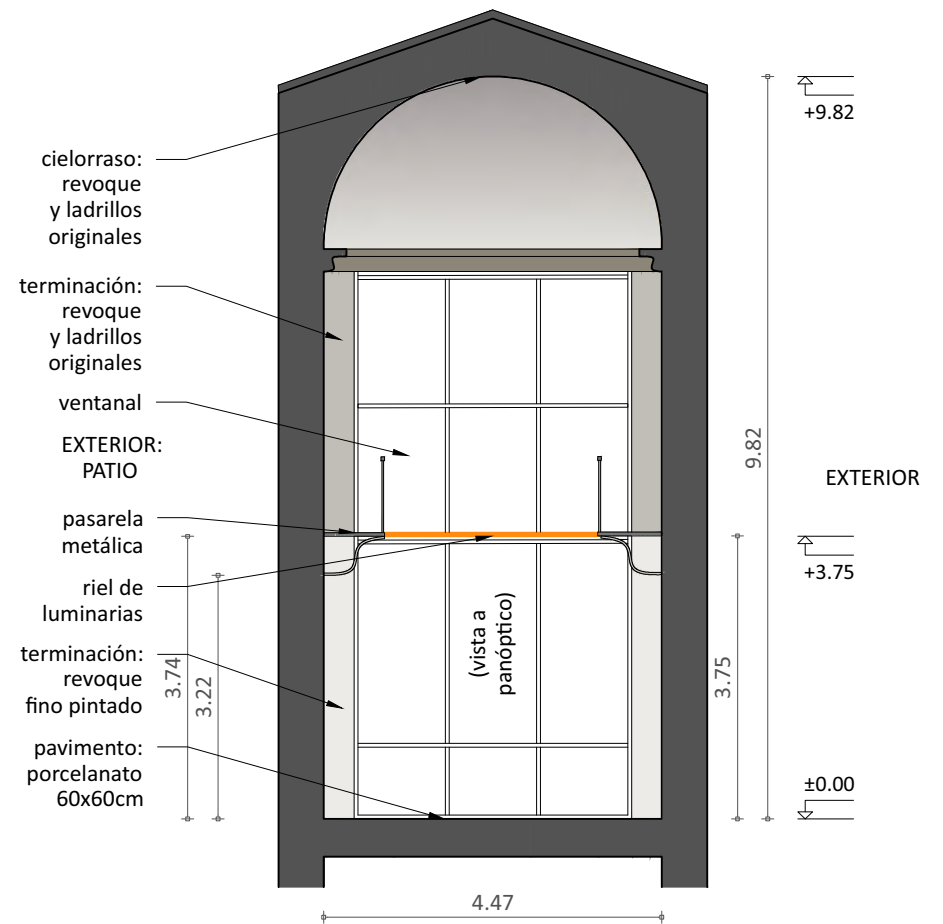

# Espacio Cinco

## Corte BB Escala 1:100

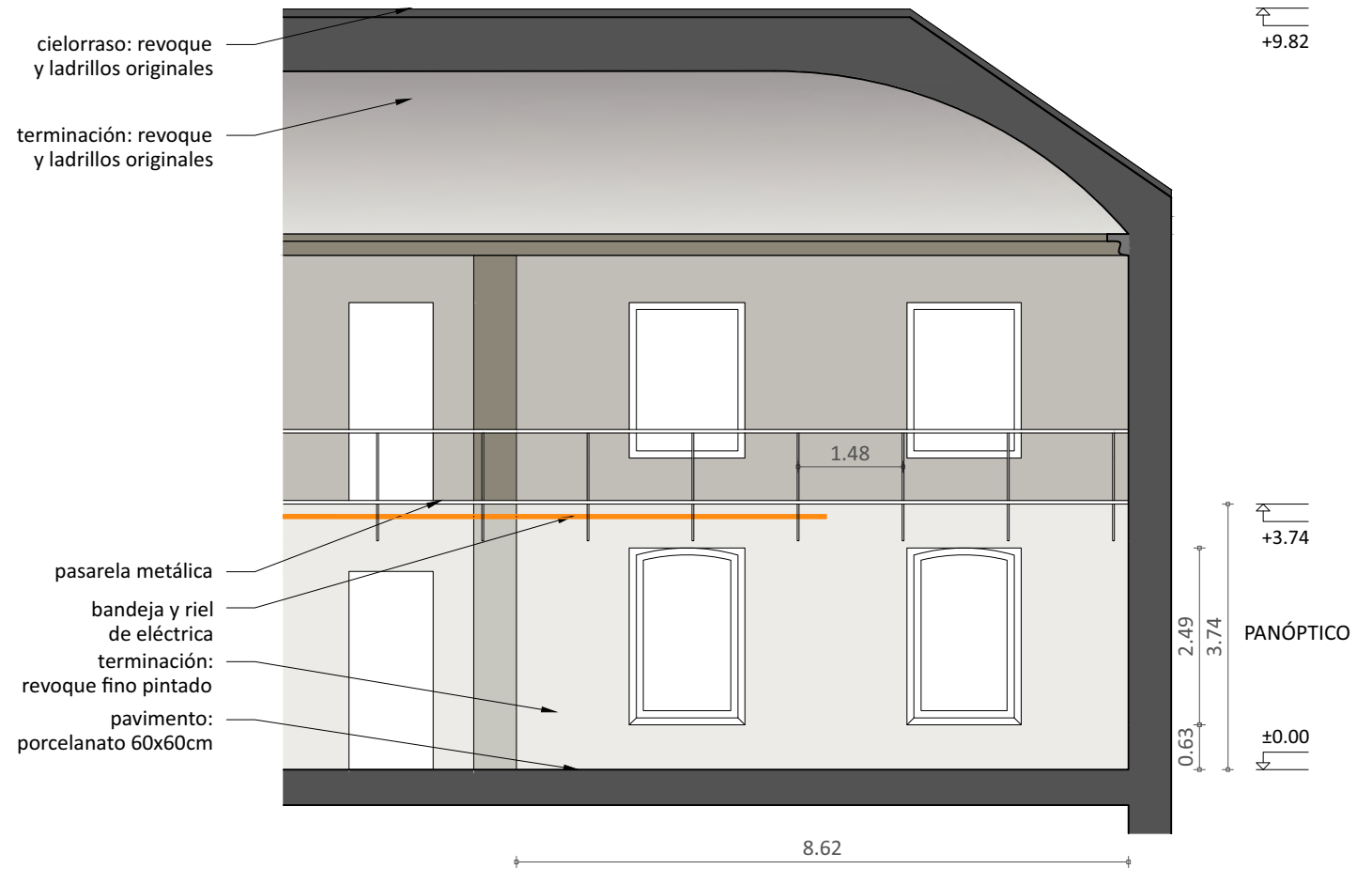



# Espacio Cinco

## Corte CC Escala 1:100

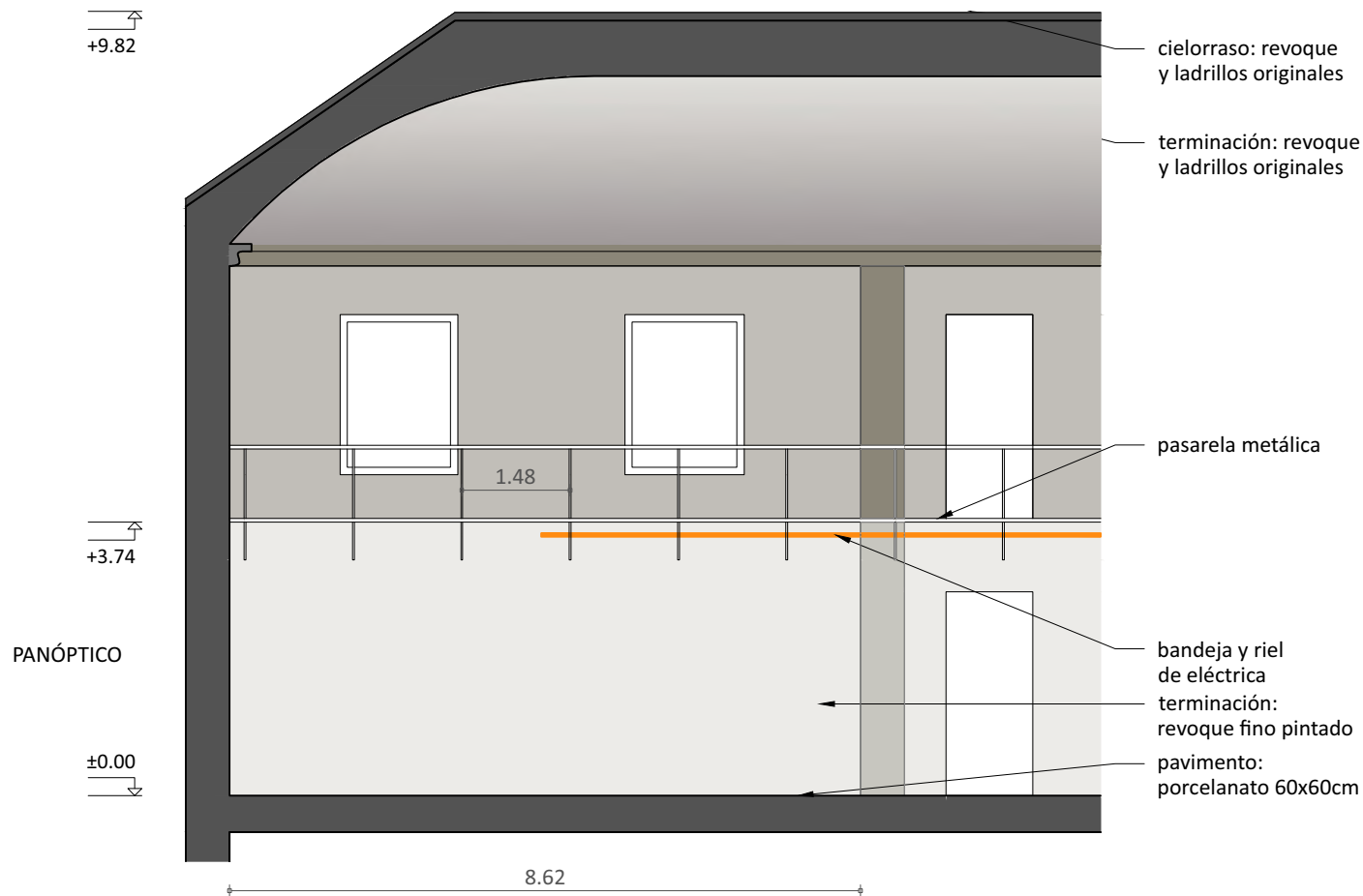

# Sala Seis

Planta baja y  
ubicación de sala  
Escala 1:500

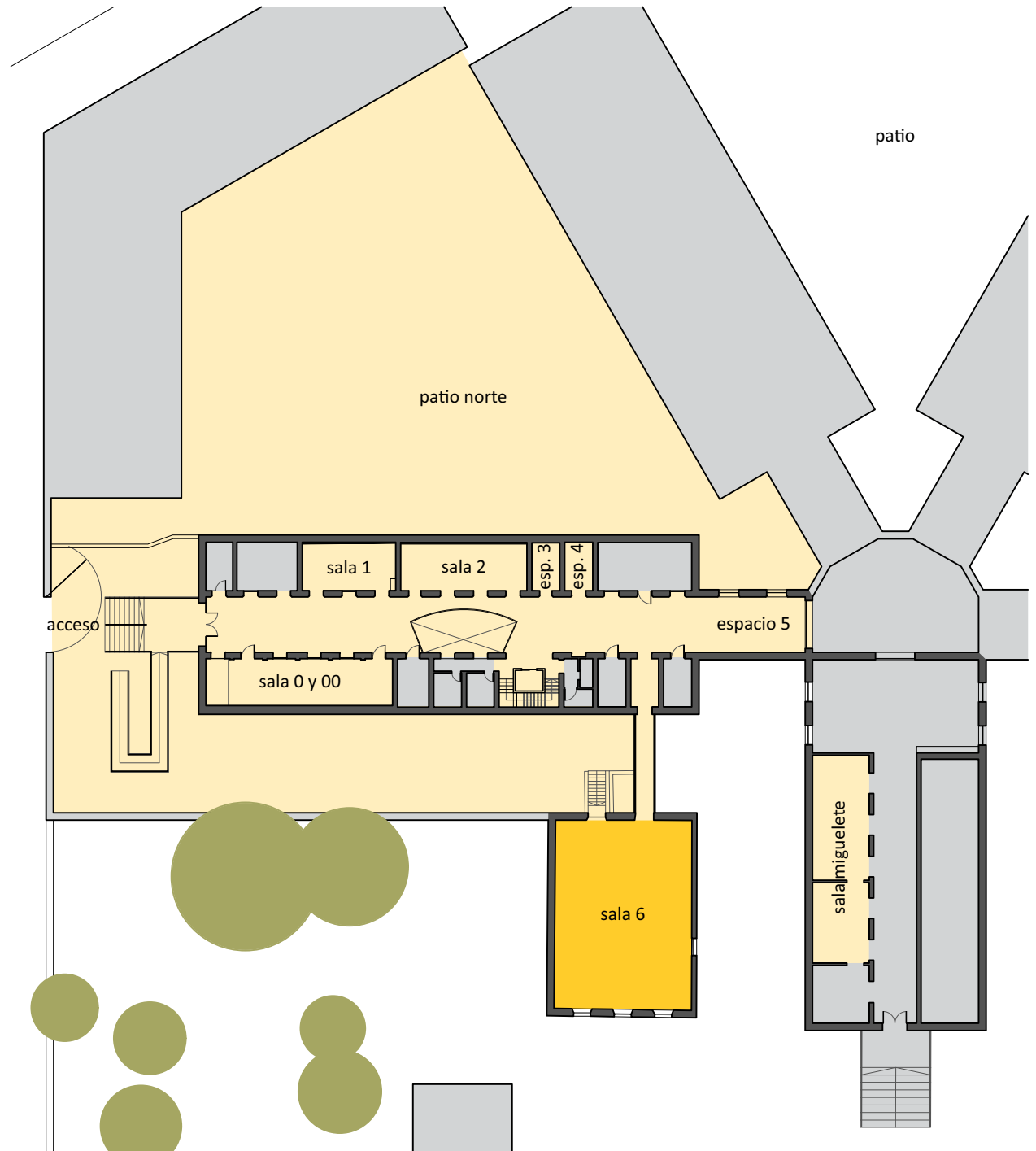

# Sala Seis



## Vistas





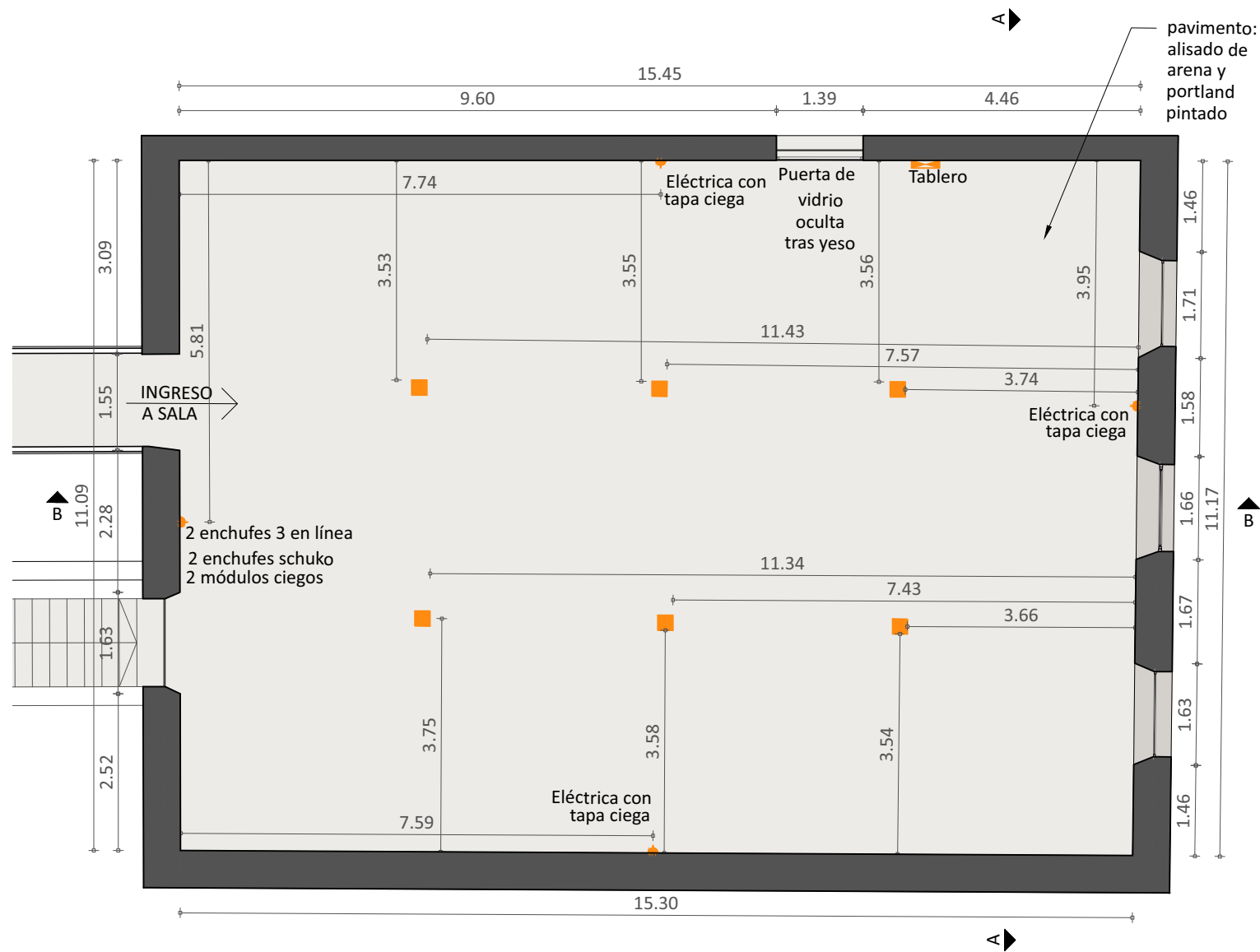
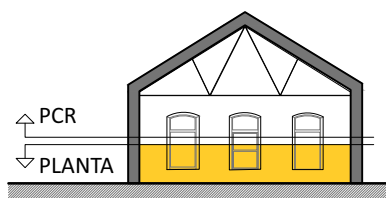

# Sala Seis

## Planta Escala 1:100



### Referencias:

-  Tablero en pared
-  Tomacorriente o previsión (tapa ciega) en pared
-  Tapa en piso (de 24x24cm):  
2 tomacorriente 3 en línea, 2 tomacorriente schuko, 6 módulos ciegos

# Sala Seis

## Planta de cielorraso reflejado (PCR)

Escala 1:100

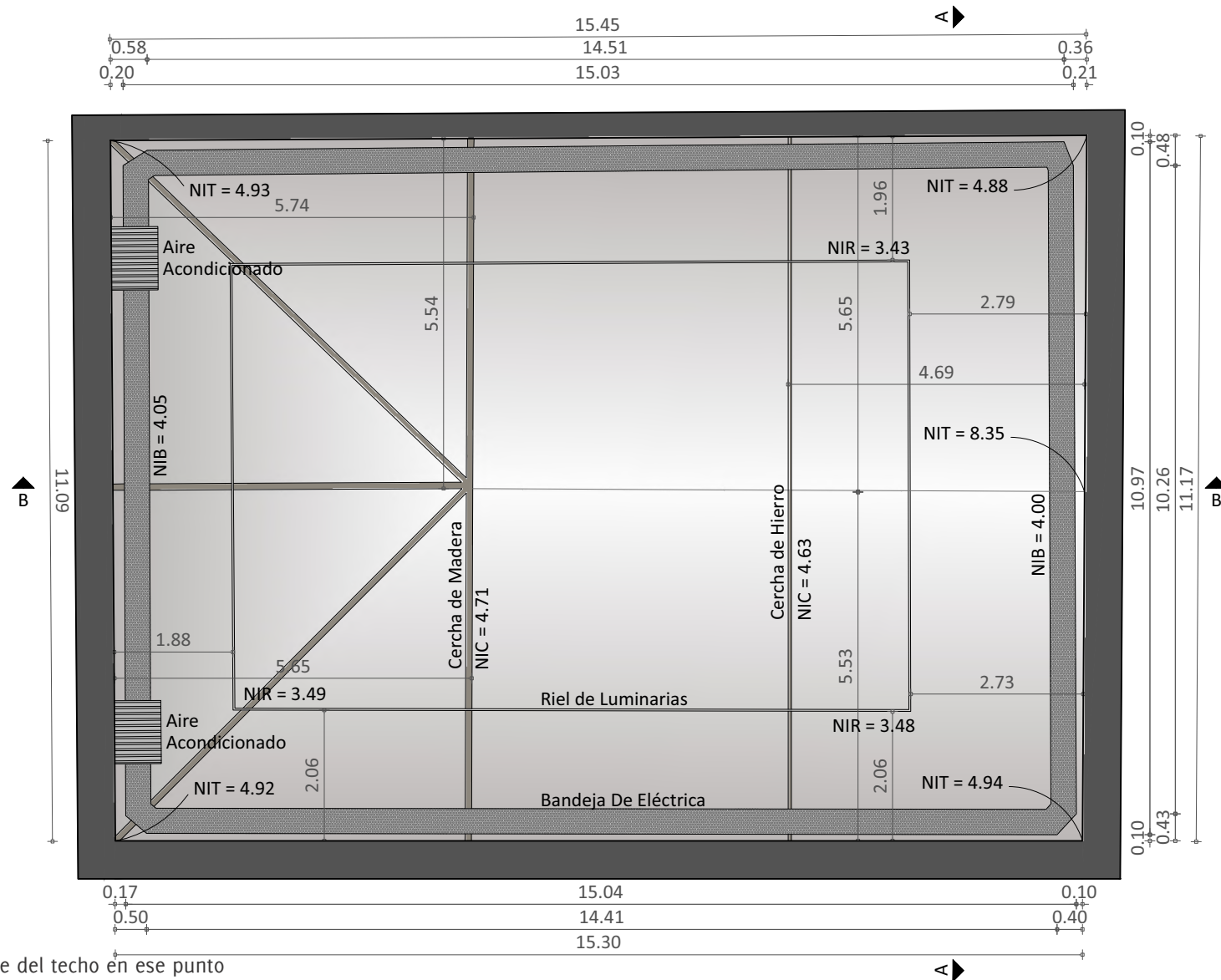

### Referencias:

NIVEL INFERIOR: altura desde el piso hasta la base del techo en ese punto

NIT = Nivel Inferior De TECHO

NIC = Nivel Inferior De CERCHA

NIB = Nivel Inferior De Bandeja De Eléctrica

NIR = Nivel Inferior De Riel de Luminarias

# Sala Seis

## Corte BB

Escala 1:100

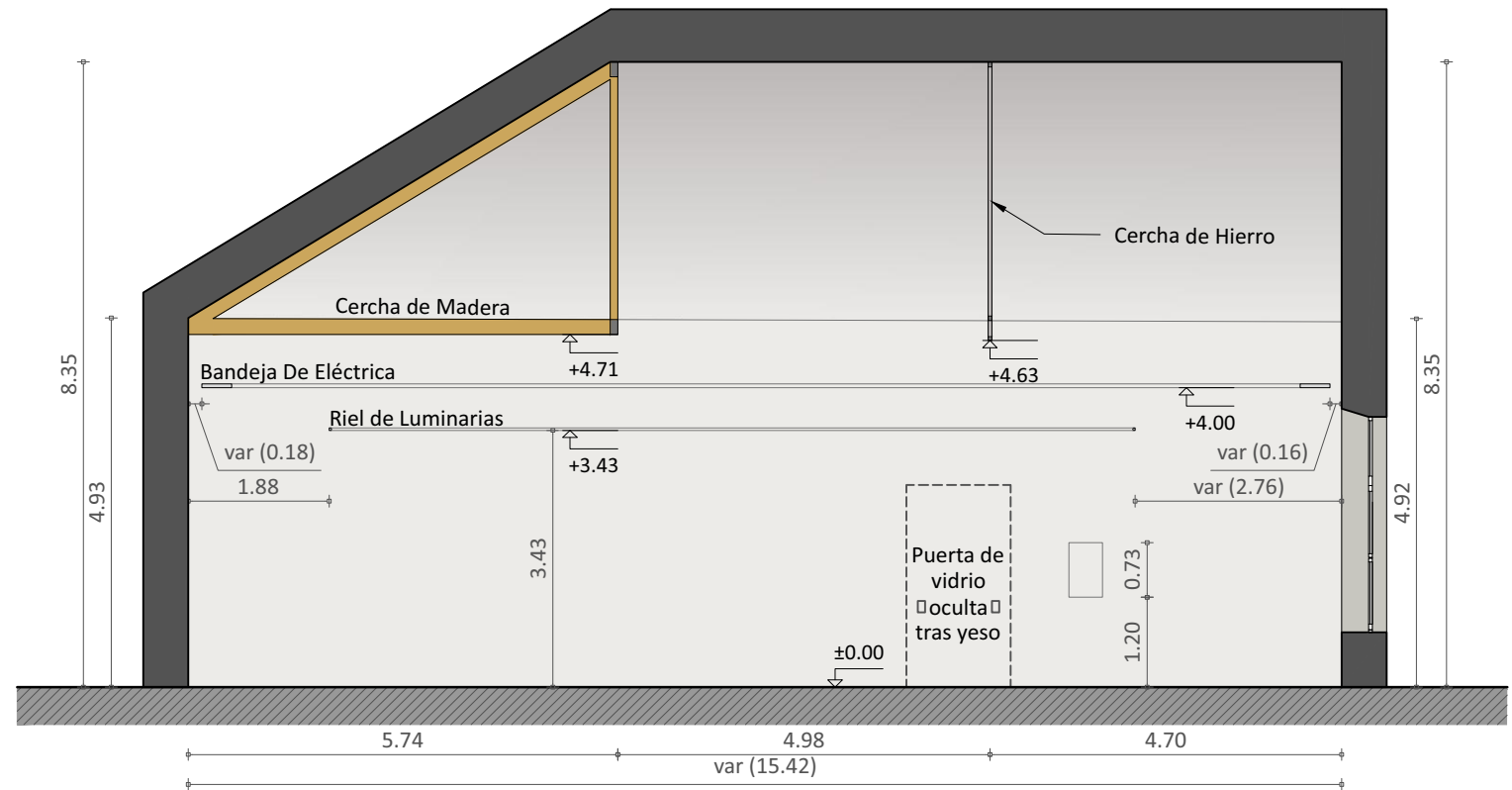

### Referencias:

var (1.00): medida variable, mide 1.00 en línea de corte

# Sala Miguelete

Planta baja y  
ubicación de sala  
Escala 1:500

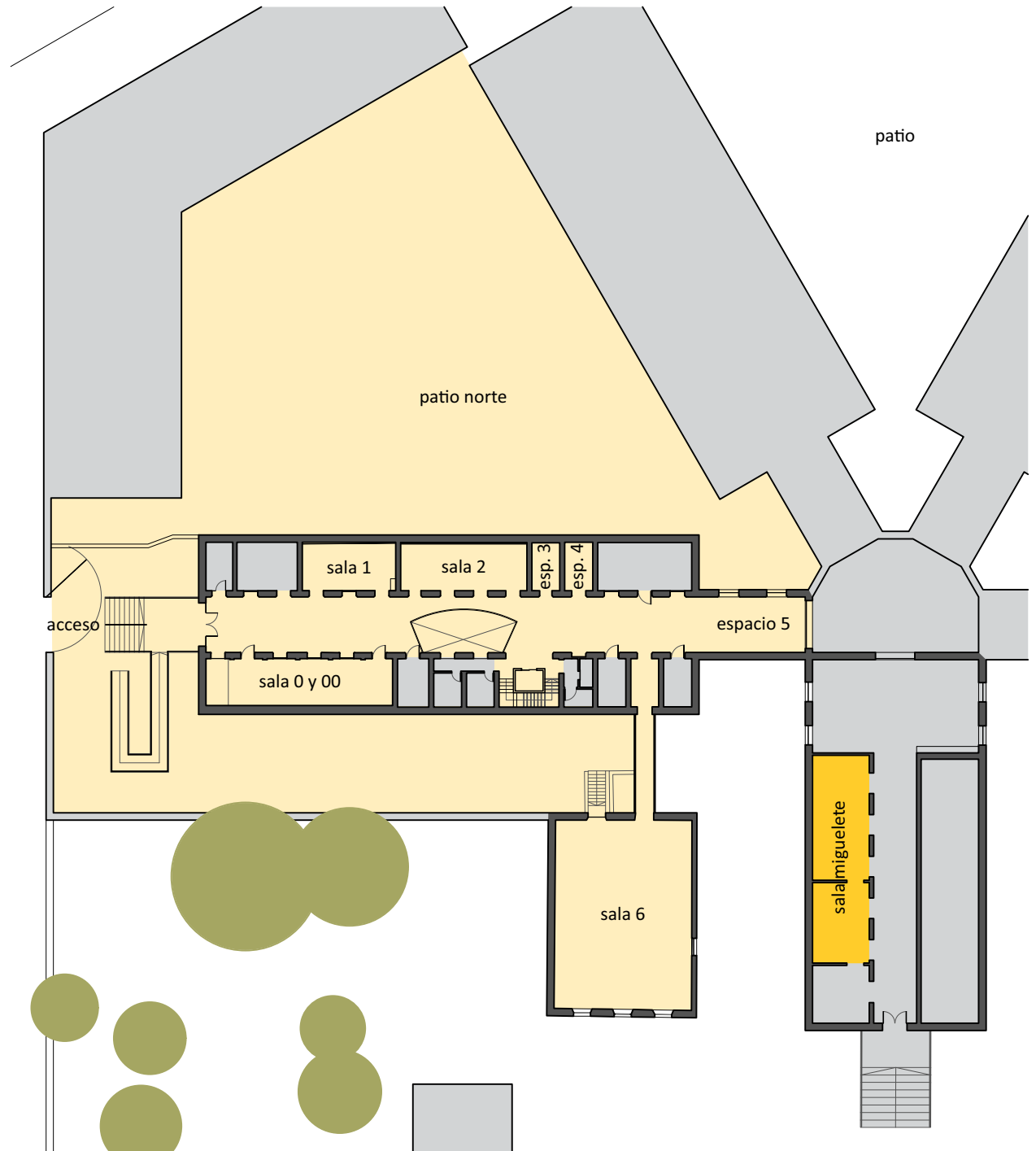





# Sala Miguelete

Corte BB  
Escala 1:100

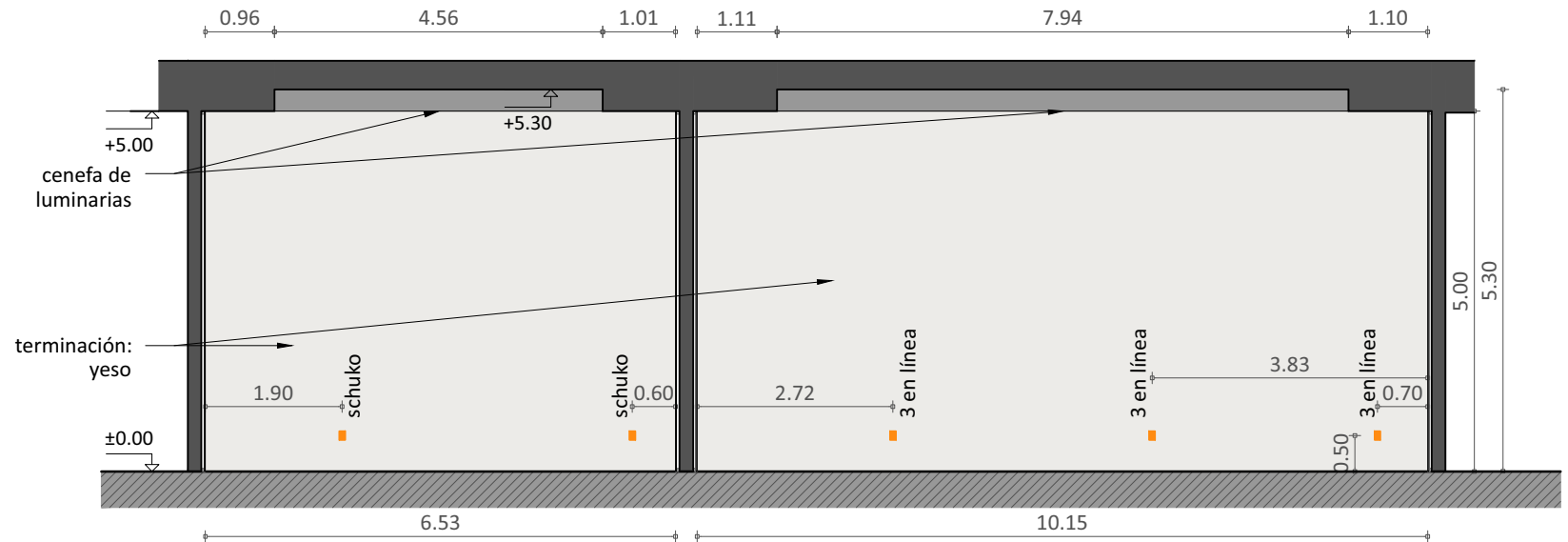

Corte CC  
Escala 1:100



**Subsuelo /  
Doce espacios  
iguales /  
Tipología**

Planta subsuelo y  
ubicación de sala  
Escala 1:500

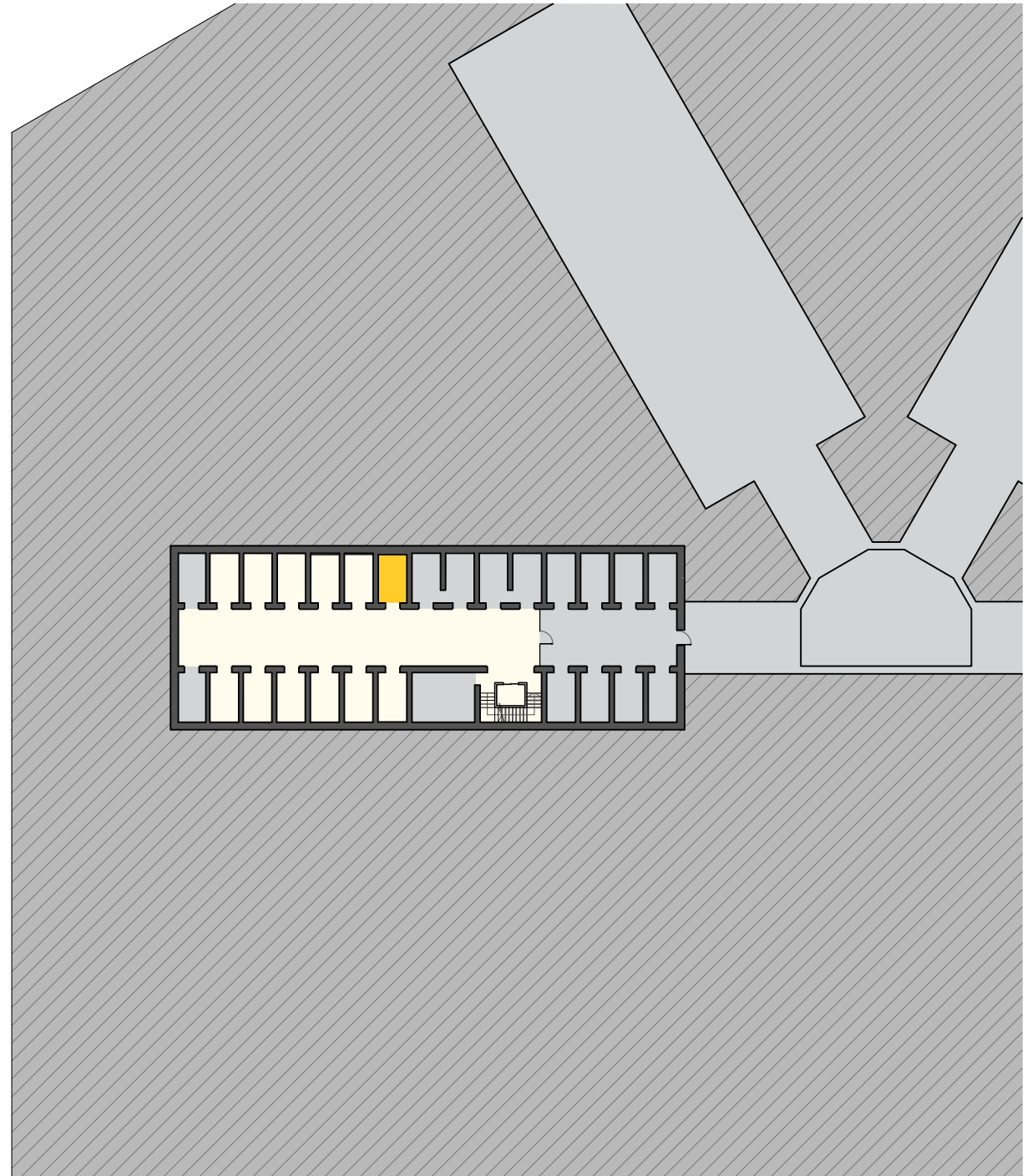

# Subsuelo / Doce espacios iguales / Tipología



## Vistas

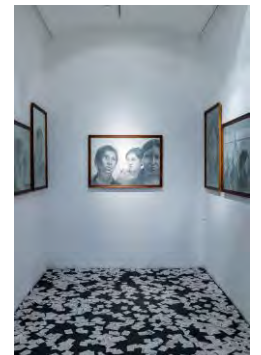

# Subsuelo / Doce espacios iguales / Tipología

Planta  
Escala 1:100

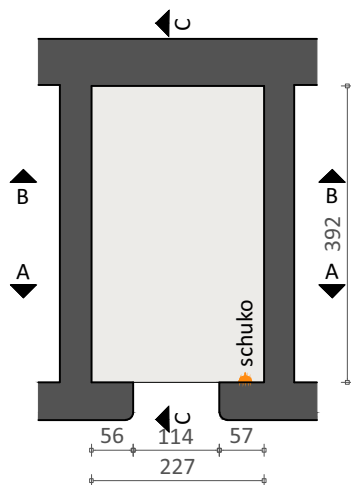

Corte AA  
Escala 1:100

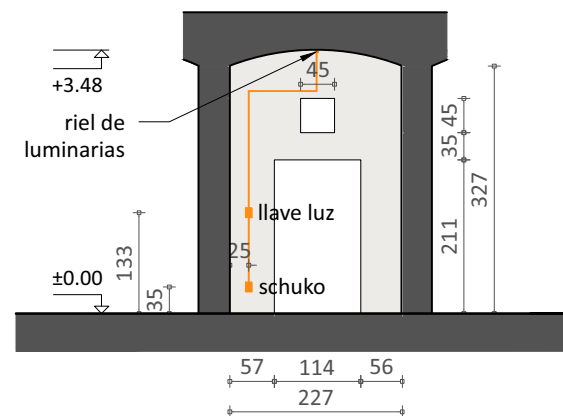

Corte BB  
Escala 1:100

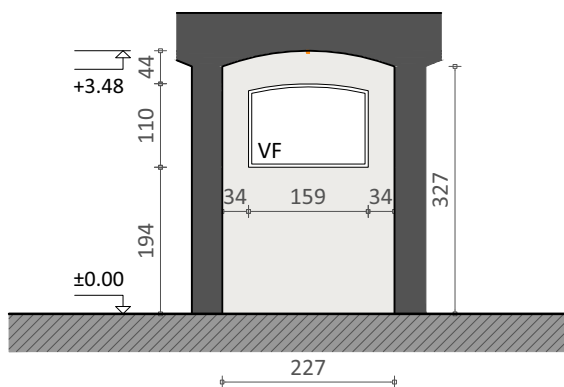

Corte CC  
Escala 1:100

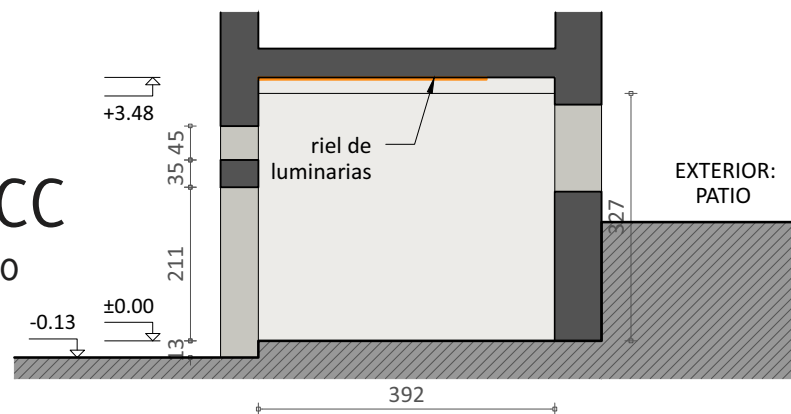

**Notas:**

- cotas promedio en centímetros
- las ventanas pueden permanecer abiertas o ser tapiadas.

# Planta Baja / Nave Central

Planta baja y  
ubicación de sala  
Escala 1:500

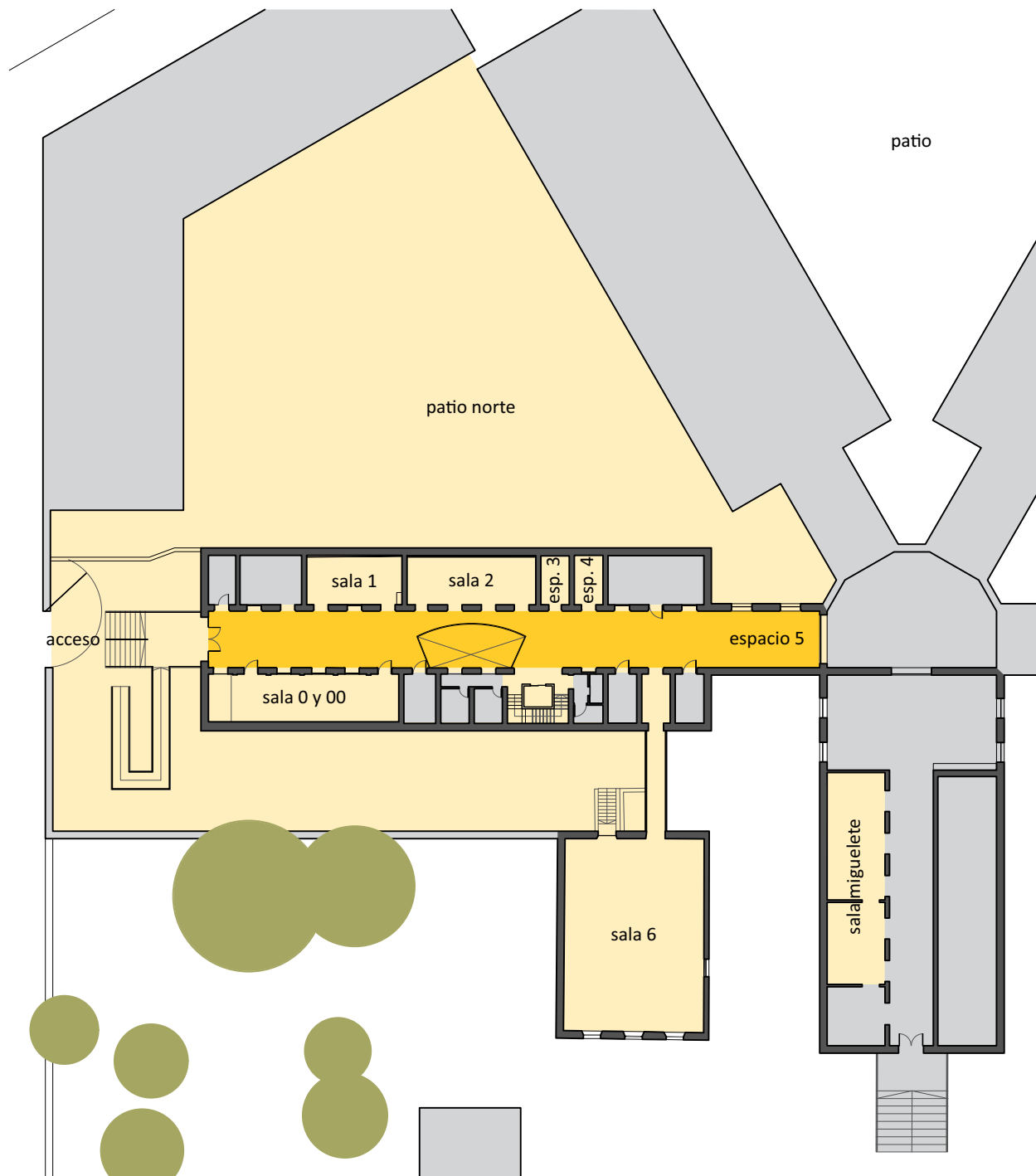

# Planta Baja / Nave Central



Vistas

# Planta Baja / Nave Central

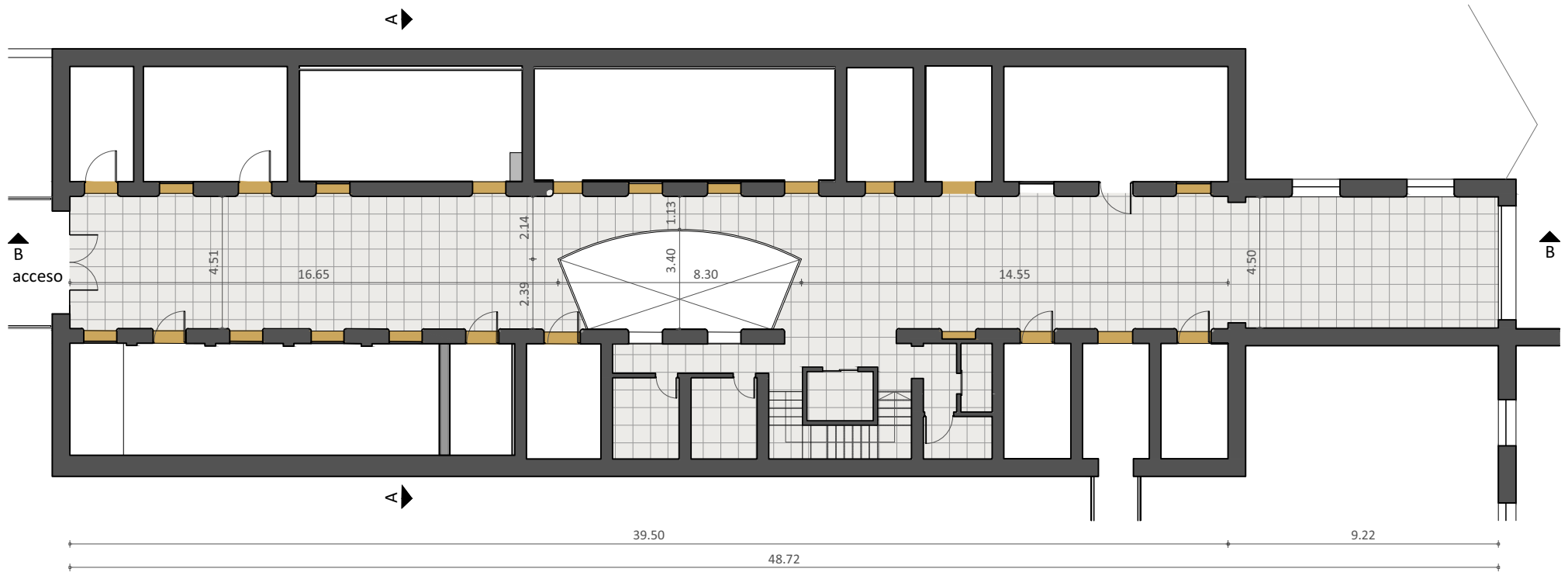

Planta  
Escala 1:200



# Planta Baja / Nave Central

## Corte AA

Escala 1:200

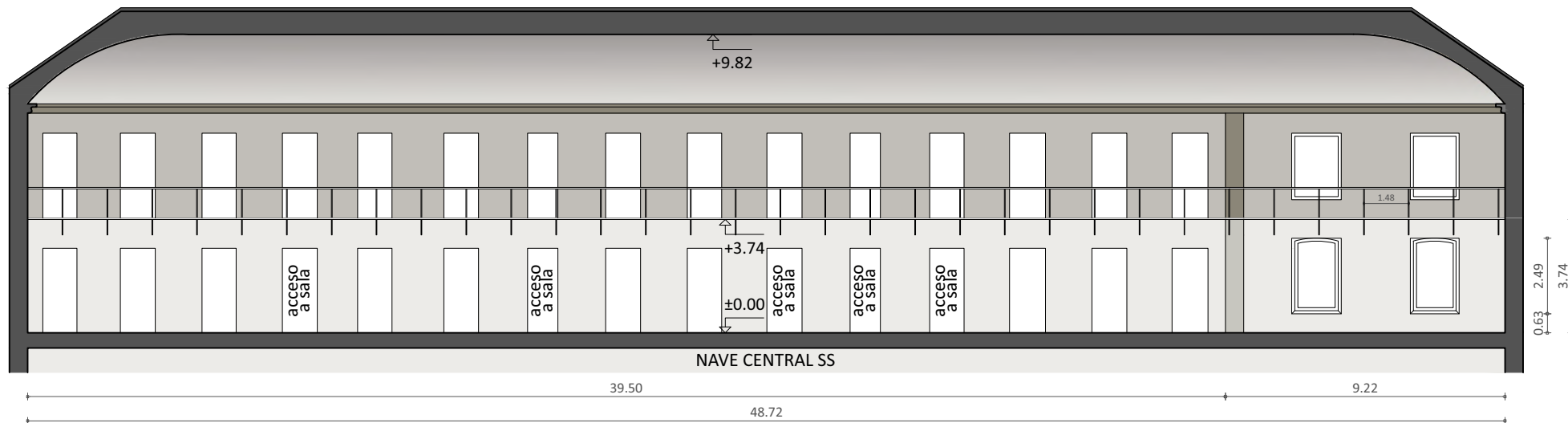
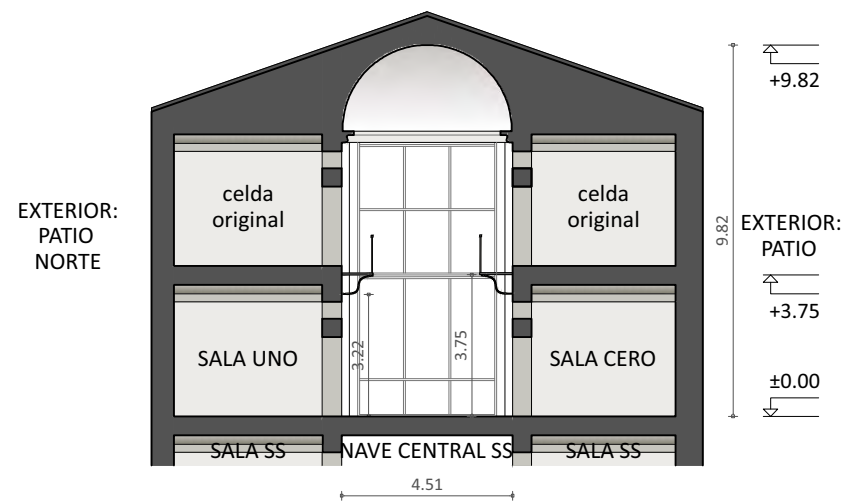

## Corte BB

Escala 1:200

# Subsuelo / Nave Central

Planta subsuelo y  
señalización de nave  
Escala 1:500

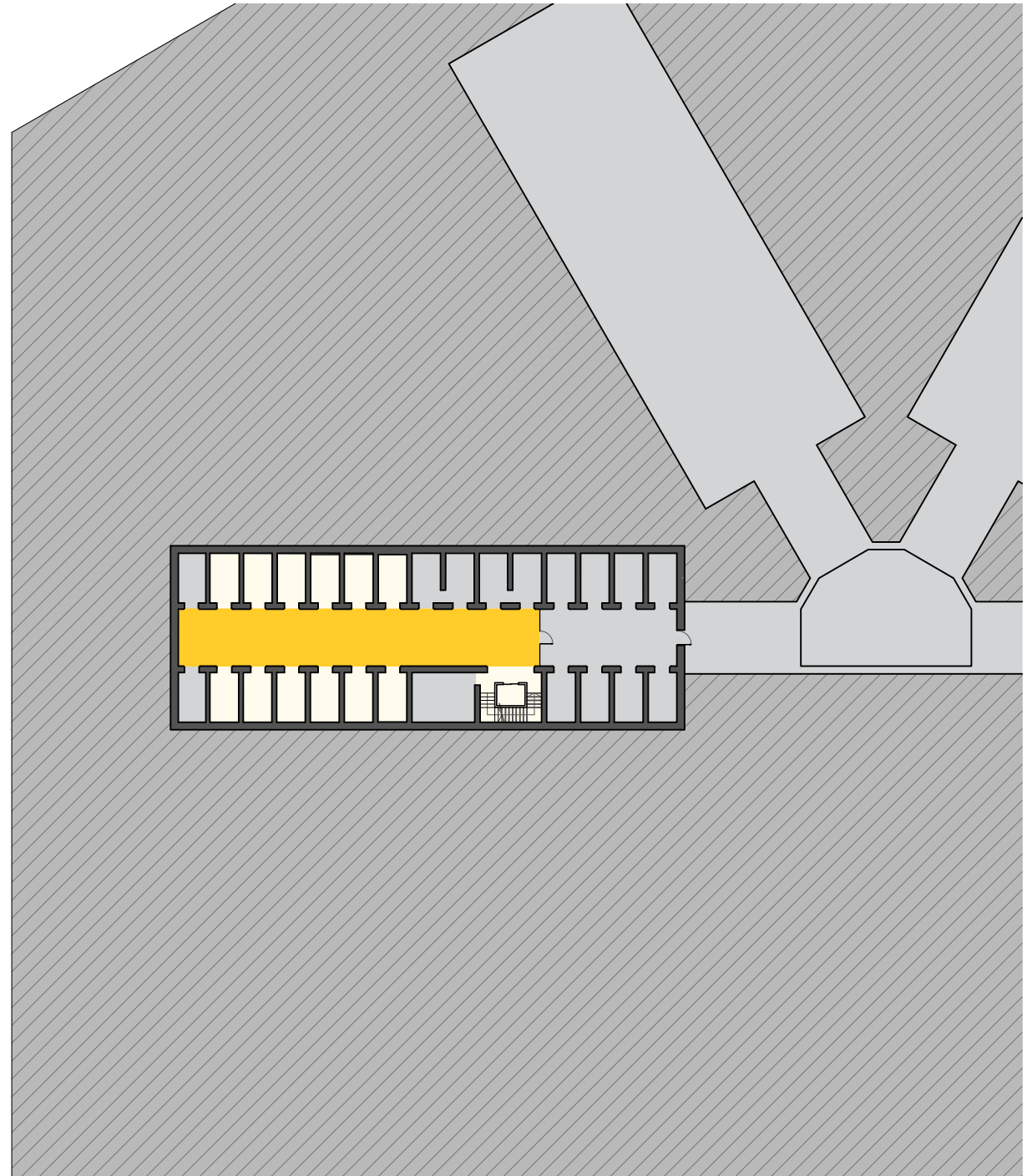

# Subsuelo / Nave Central



## Vistas

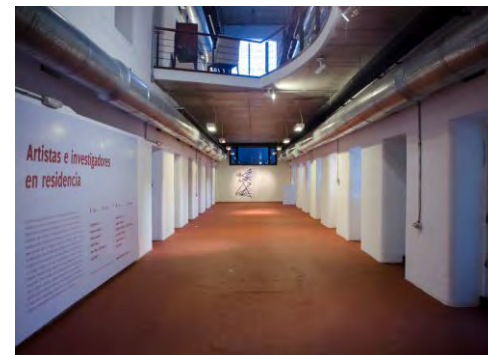

# Subsuelo / Nave Central

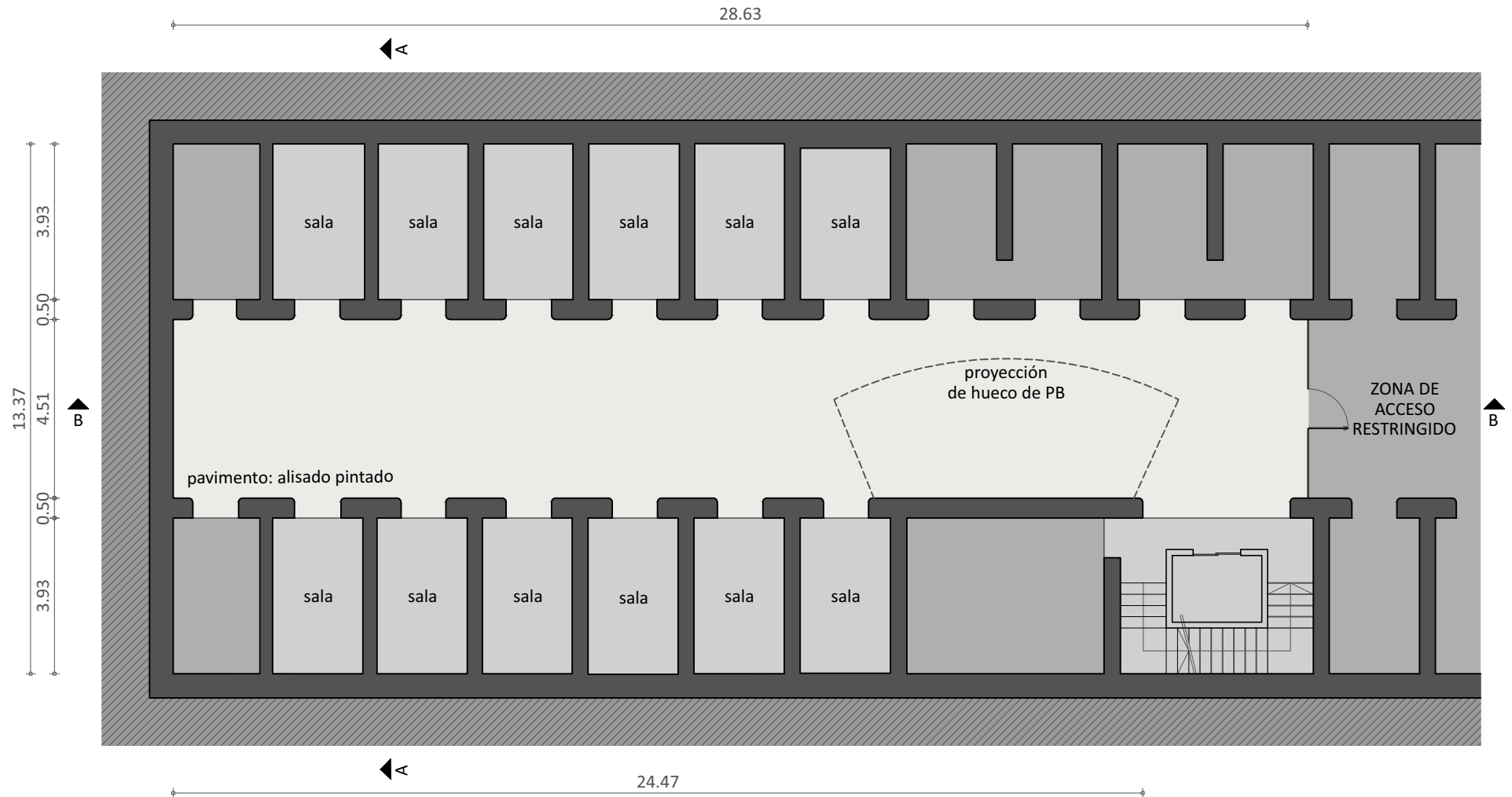

Planta  
Escala 1:150

# Subsuelo / Nave Central

Corte AA  
Escala 1:150

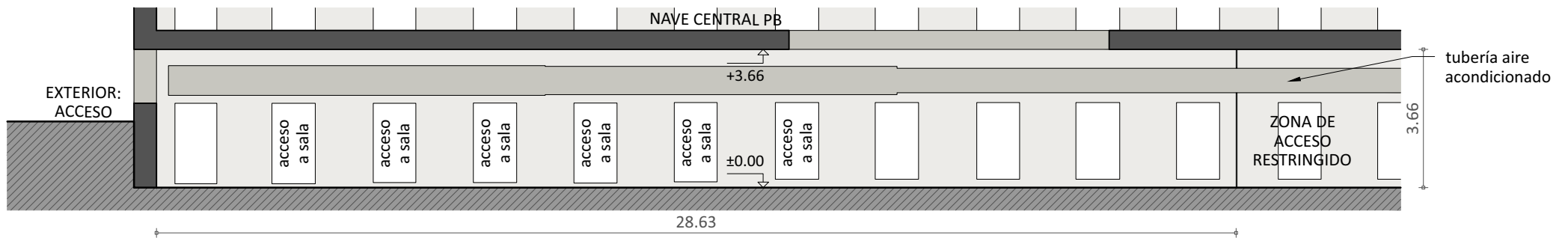
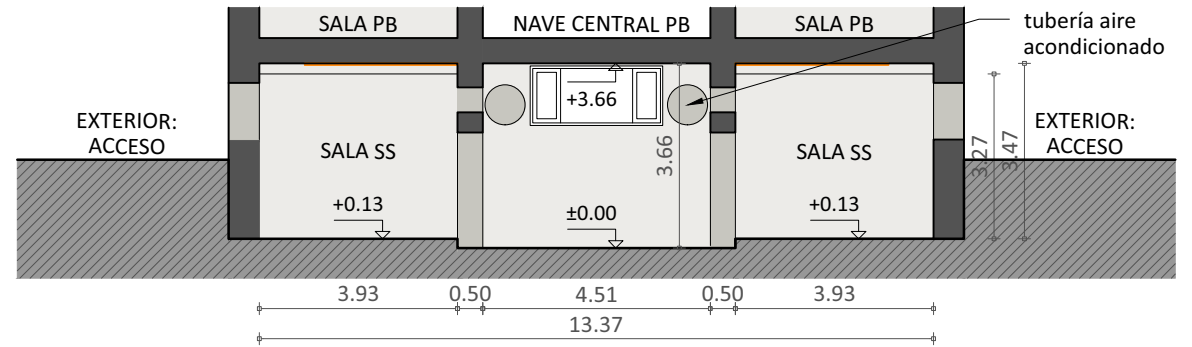

Corte BB  
Escala 1:150

# Patio Norte

Planta baja y  
ubicación de patio  
Escala 1:500



# Patio Norte



Vista

# Patio Norte

Planta  
Escala 1:500

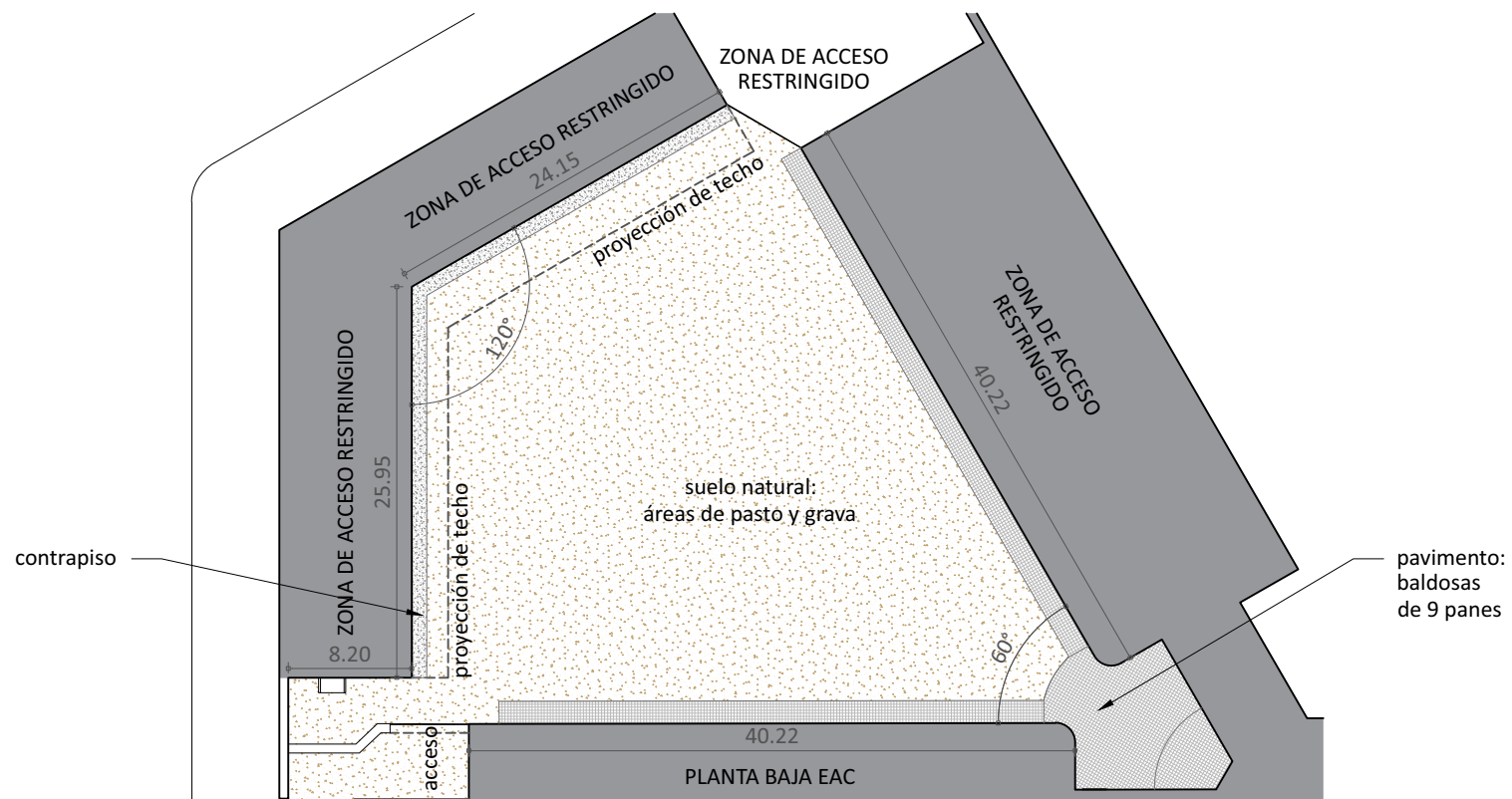

Nota:

Medidas aproximadas